

DuoFlex®

Assembly instructions

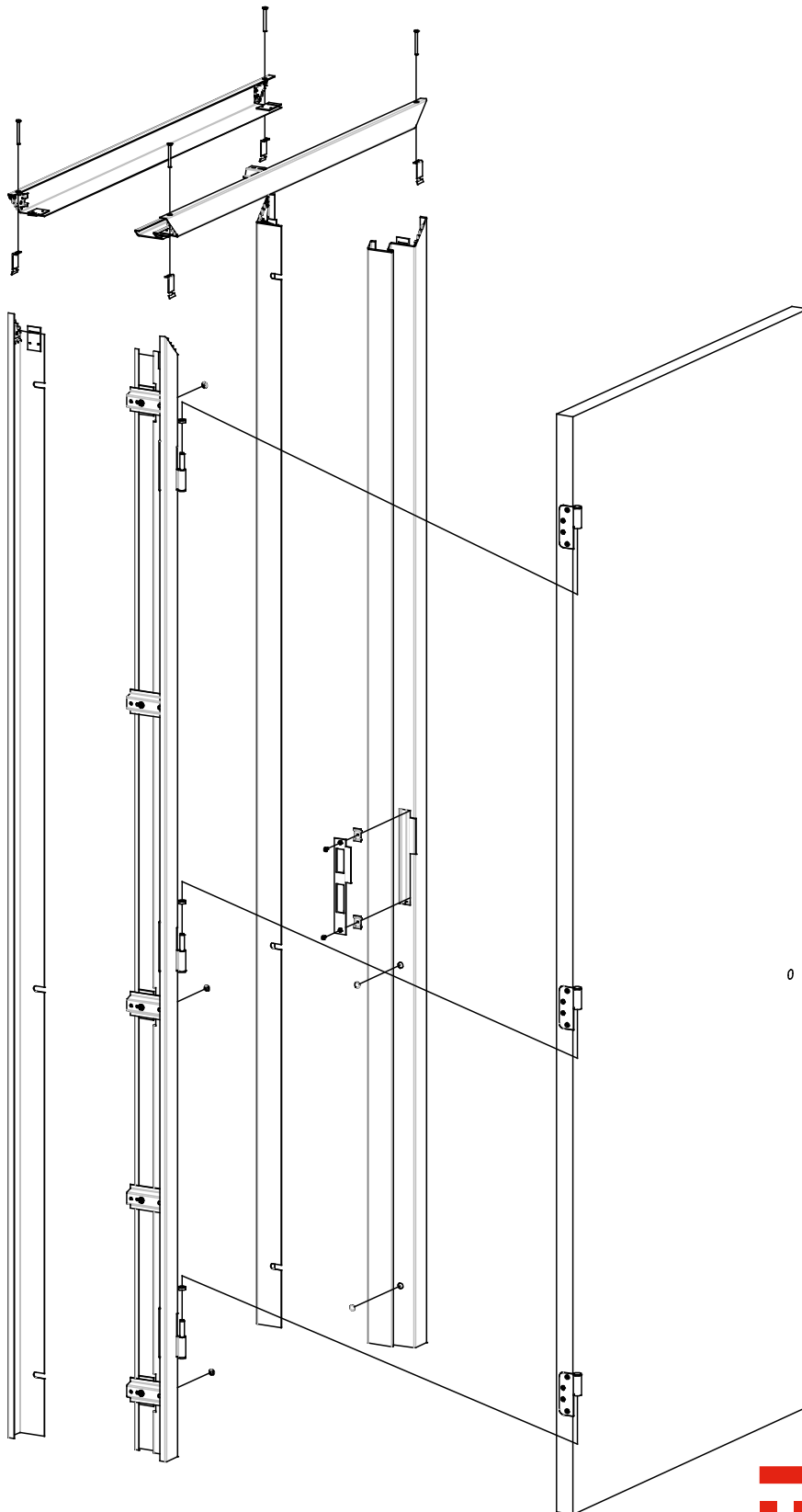

DuoFlex assembly frame

Table of contents

How do you use this manual?	2
DuoFlex frame components	3
Check	5
Assembling the front half	6
Assembling the back half	7
Installing the front half	8
Installing the back half	9
Assembly with wall thickness of 150 mm or more	10
DuoFlex frame, fire resistant	11
DuoFlex frame, fire resistant, filled with foam	12
DuoFlex frame, fire resistant, filled with mineral wool	12
DuoFlex frame, fire resistant, filled with a combination of mineral wool and foam	13
DuoFlex frame, fire resistant, filled with gypsum plaster	13

How do you use this assembly manual?

This manual provides you with step by step instructions for installing DuoFlex assembly frames. This manual contains illustrated and written instructions.

Note! Assembly sequence with mirrored versions:

The assembly instructions in this manual are for a frame system for a left-hung door.

Left-hung/right-hung door

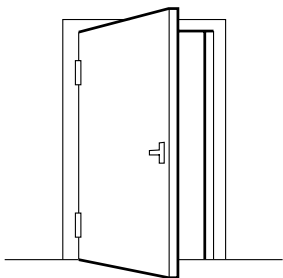

left-hung *

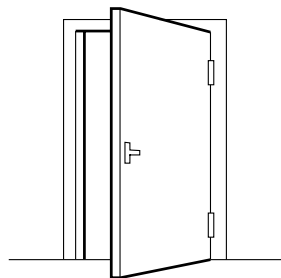

right-hung*

* Door swings towards you

This documentation is subject to change.

DuoFlex frame components

The DuoFlex frame consists of two main components, the front half and the back half. Each half consists of two vertical parts and one horizontal part.

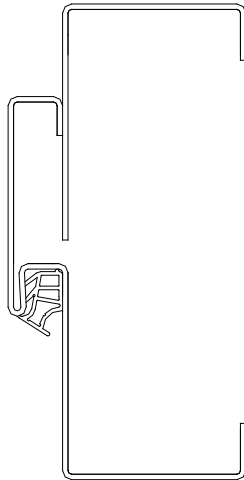

Front half x 3



Stainless steel bolt x 2



Back half x 3



Cover cap x 7



Mitre joint bracket x 4

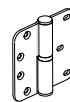

Lift-off hinge with ring x 3



Sunken screw x 4



Bolt x 9



Clamp plate x 2



Stripping x 1, see page 9



Strike plate x 1

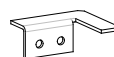

Wall bracket for wall thickness of 150 mm or more x 2, see page 10

Parts and auxiliary tools

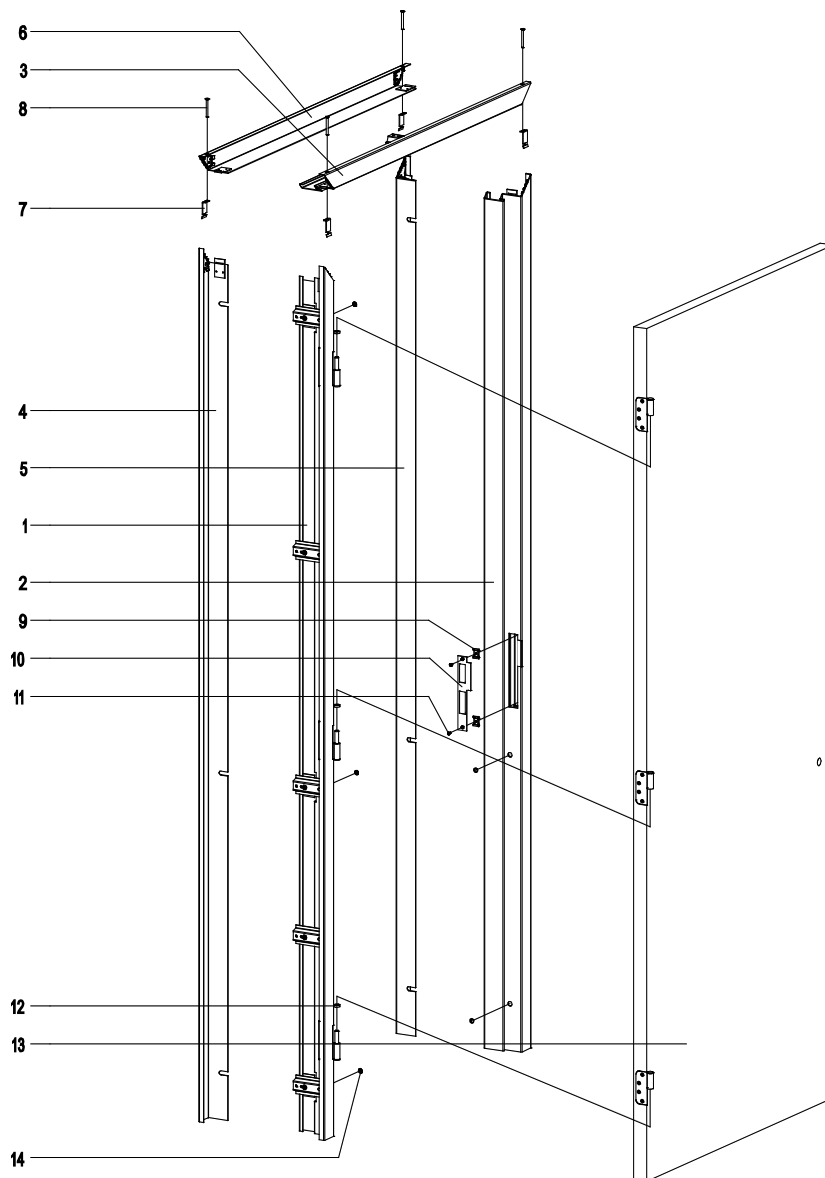

Parts

1. Front half, left
2. Front half, right
3. Front half, upper lintel
4. Back half, left
5. Back half, right
6. Back half, upper lintel
7. Mitre joint bracket
8. Sunken screw
9. Clamp plate
10. Strike plate
11. Stainless steel bolt
12. Lift-off hinge with ring
13. Door
14. Cover cap

Axiliary tools

- Measuring tape
- Spirit level
- Open-end spanner, SW 13
- Phillips screwdriver
- Drill
- Glue clamp
- Combination clamp / universal clamp
- Extended bit holder
- Mounting blocks

Check

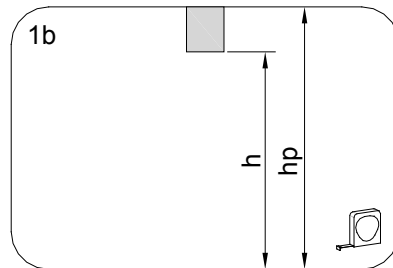
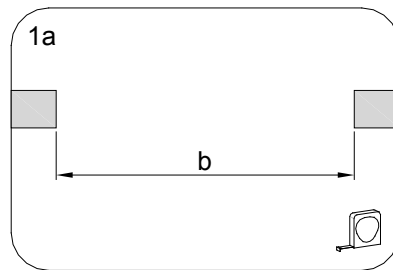
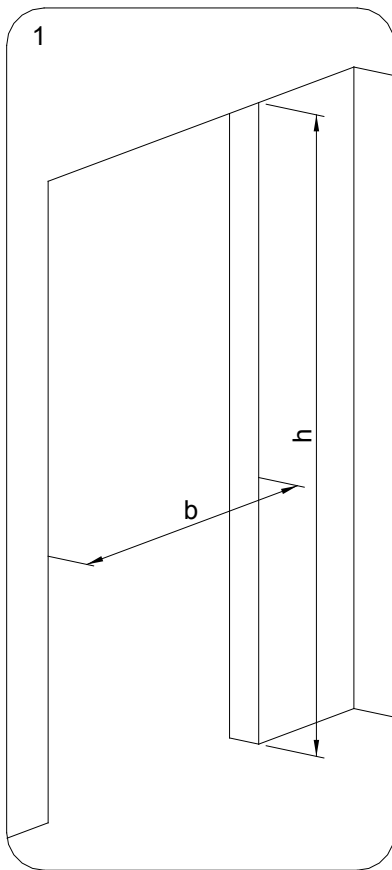

1 Check the recess

Take the frame components out of the packaging.

Check the frame components for any damage.

1a

Door width	b
930	1000
980	1050
1030	1100

1b

Door height	h	hp min.
2015	2050	h + 30
2115	2150	h + 30
2315	2350	h + 30

Tolerance depends on the model.

The DuoFlex frame can handle differences in wall thickness, as indicated in the table.

Door thickness	Wall thickness	Tolerance	
		-	+
40	90	0	10
40	≥ 100	-5	+10
50	100	0	10
50	≥ 110	-5	+10
54	≥ 110	-5	+10

Assembling the front half

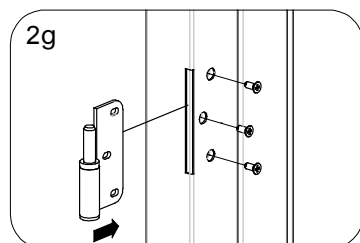
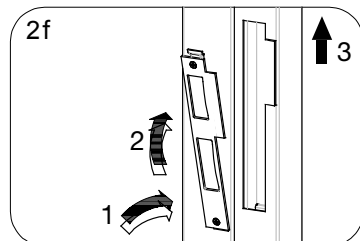
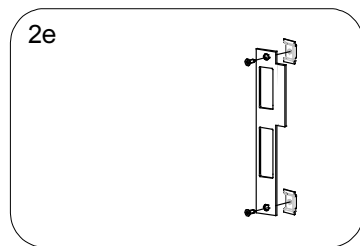
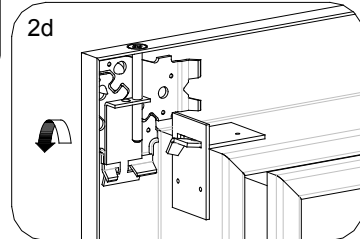
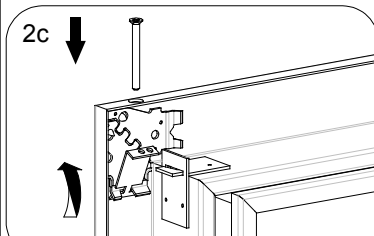
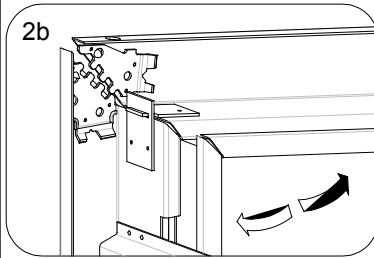
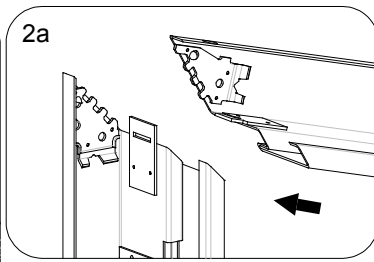
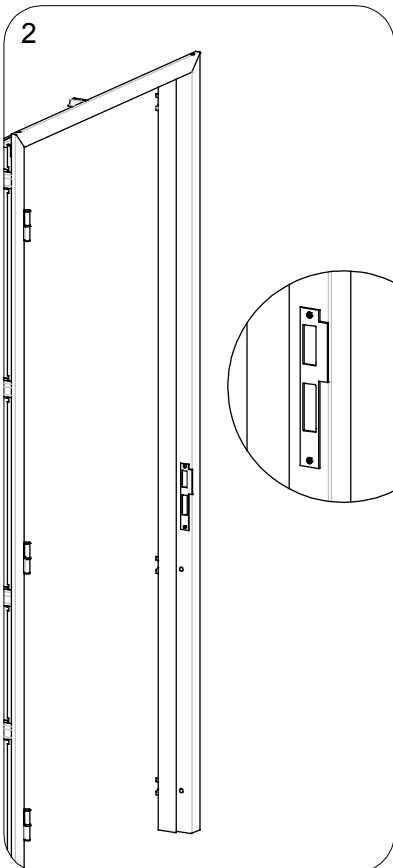
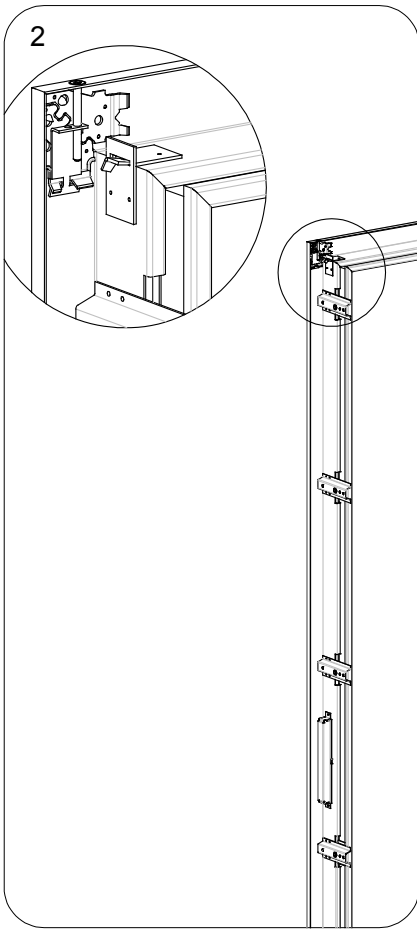

It is advisable to use wooden supports to avoid damaging the frame.

2a Assemble the upper lintel by inserting the lip into the counter plate. Hold the profiles at a slight angle to each other.

2b Make sure the teeth engage properly by moving the profiles towards each other. Check that the front faces are level.

2c Position the mitre joint bracket and fasten it with a sunken screw.
2d Twist the lip inwards (towards the frame surface).
Repeat for the other frame leg.

2e Fit the clamp plates loosely on the strike plate using the stainless steel bolts.

2f Fit the strike plate into the strike box. Position the strike plate and make sure the front side is level with the frame. Screw in the stainless steel bolts using a Phillips screwdriver.

2g Insert the lift-off hinge in the slot of the frame. Make sure the front side of the plate is level with the inside of the frame. Fasten the lift-off hinge with the supplied stainless steel bolts.

The lift-off hinges are fitted with slot holes so that these can be adjusted when needed.

Assembling the back half

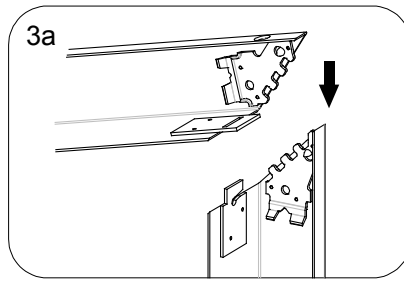
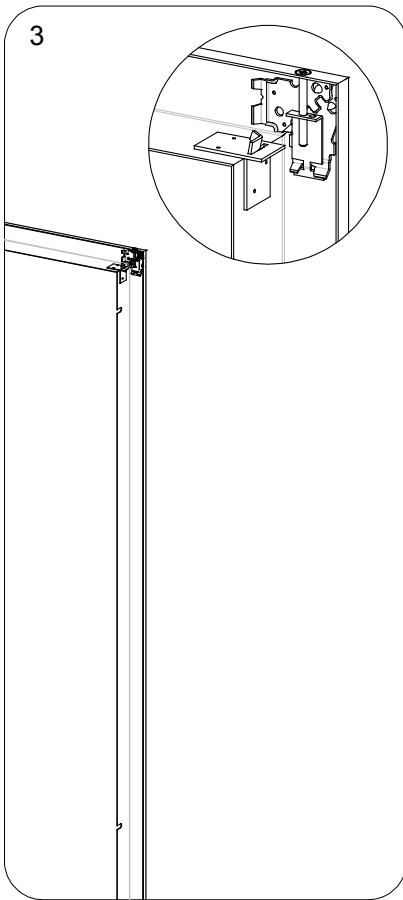

It is advisable to use wooden supports to avoid damaging the frame.

3a Assemble the upper lintel by inserting the lip into the counter plate. Hold the profiles at a slight angle to each other.

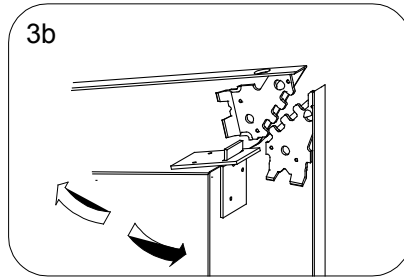

3b Make sure the teeth engage properly by moving the profiles towards each other. Check that the front faces are level.

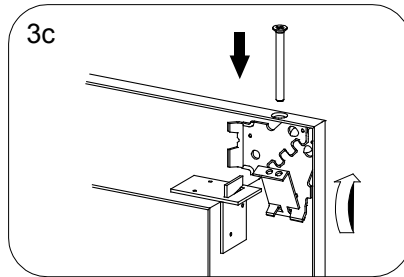

3c Position the mitre joint bracket and fasten it with a sunken screw.

3d Twist the lip inwards (towards the frame surface).

Repeat for the other frame leg.

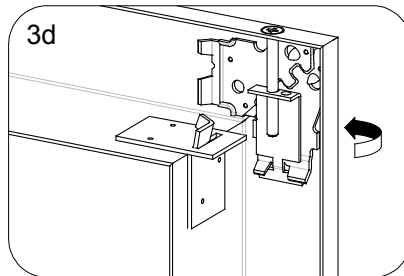

Installing the front half

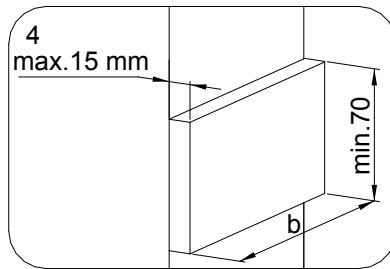
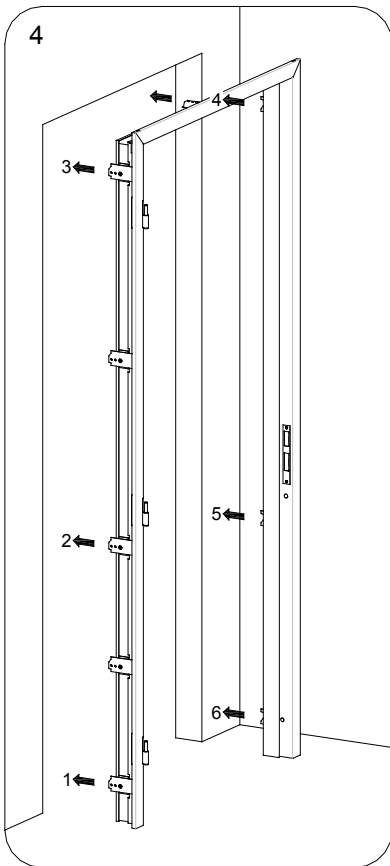

Preparation:

Mount the mounting blocks on the wall. Thickness max. 15 mm, height min. 70 mm. Width (W) is equal to wall thickness. (Note! Not supplied.)

Three per stile, back side mounting blocks level with the back side wall, position these at the height of the slotted brackets (1 to 6).

Wall mounting is dependent on wall type, for example, sunken wood screws, min. Ø 5 mm, length 50 mm and wall plugs. (Note! Not supplied.)

Note:

When positioning the mounting blocks, allow for the screw location, so that the bracket can be fastened to the mounting blocks.

Place the pre-assembled front half in the recess. Make sure that there is equal play around the frame and that the front side is properly flush against the wall. Use glue clamps as needed.

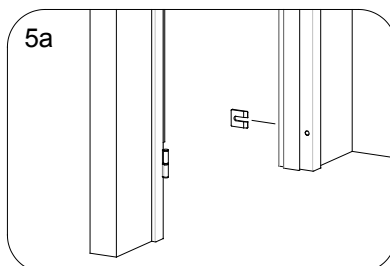
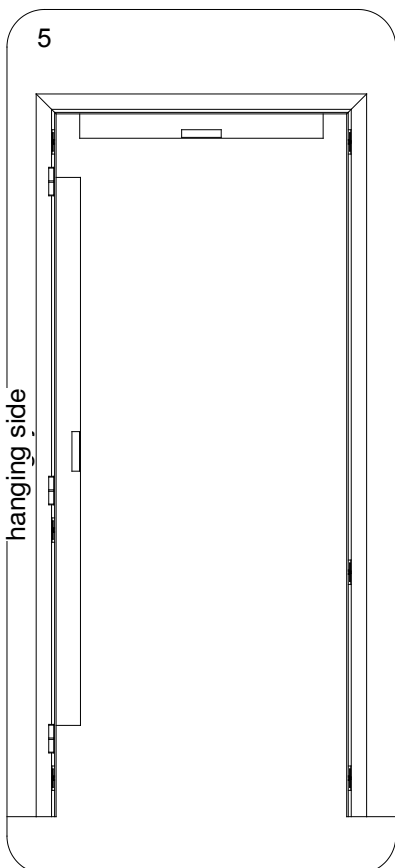

Adjust the frame so that it is level and attach the frame to the wall. Start on the side you will hang the door.

5a Fit the supplied disco clips (1 mm) into the slotted brackets to handle the unevenness of the wall and to install the frame without it being under tension.

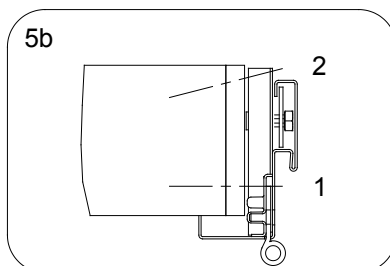

5b Attach the frame by fastening the slotted brackets into place in the correct sequence (1 then 2) using the wood screws. (Note! Not supplied.) Then place the cover caps in the groove.

Hang the door.

Check the play between the door and the frame. Adjust the frame components of the front half as needed.

Installing the back half

If wall thickness is 150 mm or more, see Figure 8 and Figure 9. If the DuoFlex product is fire resistant, see Figure 10 and 11.

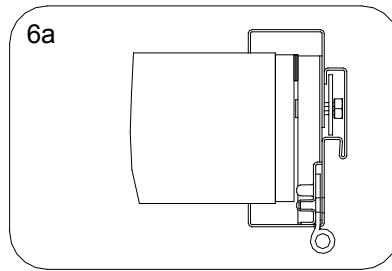
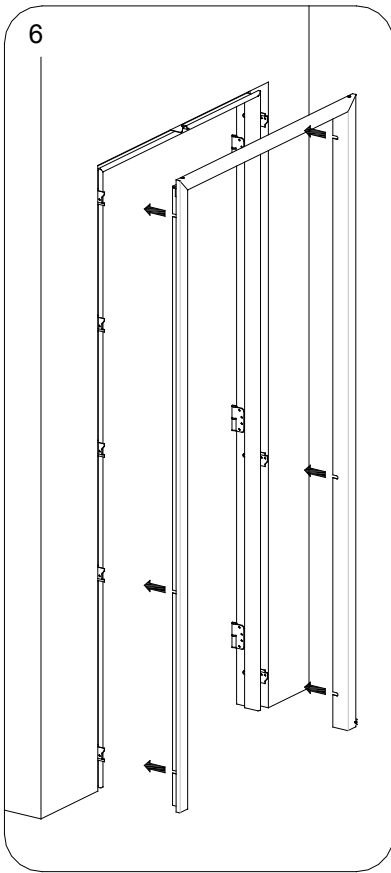

Fit the pre-assembled back half into the front half.

Make sure that the slot holes fit around the assembly bolts (M8).

Check that the back half is properly flush against the wall. Use glue clamps as needed.

6a Fasten the back half by screwing in the assembly bolts using the open-end spanner SW13.

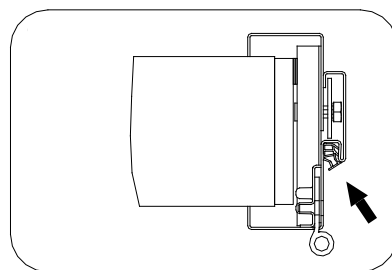
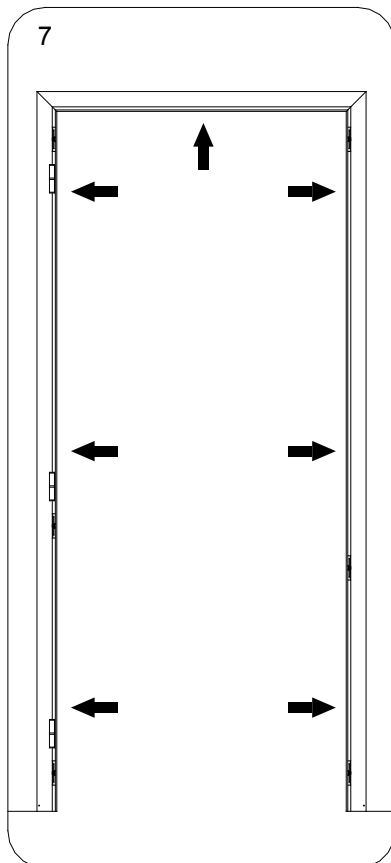

Fit the stripping.

Assembly of the back half with wall thickness 150 mm or more

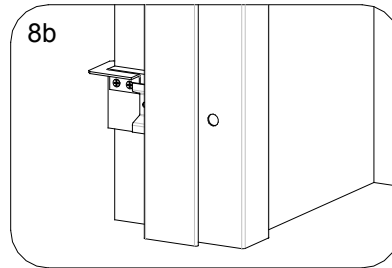
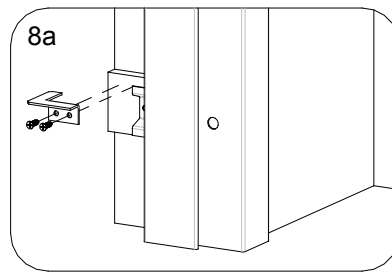
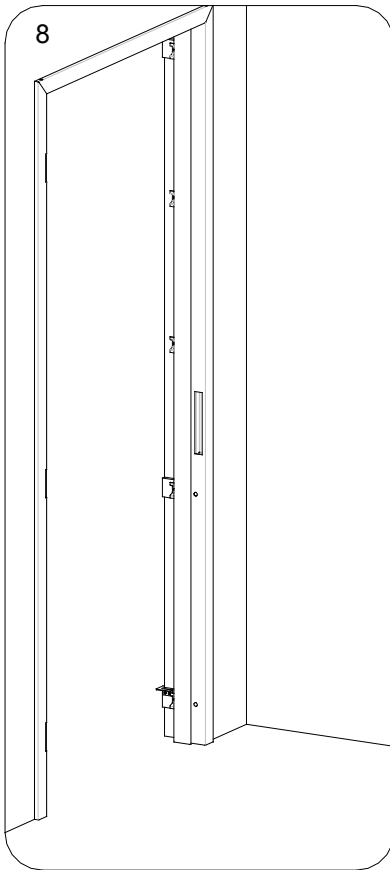

First mount the mounting blocks and the front half according to the assembly instructions.

For a wall thickness of 150 mm or more, use two wall brackets to fasten the lower side of the back half: one wall bracket on the hanging side and one wall bracket on the closing side.

8a Hanging side: fasten a wall bracket onto the mounting block using two wood screws (Note! Not supplied) on the back half side.

8b Position the wall bracket with the lip upwards and make sure that it is properly flush against the wall.

When positioning the back half, make sure the frame profile slides onto the wall brackets.

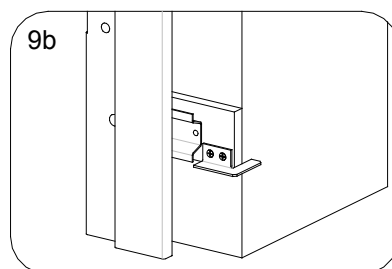
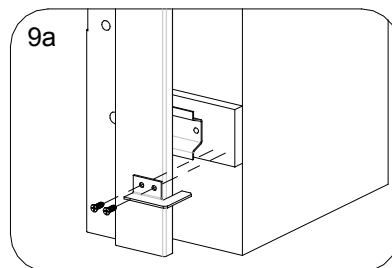
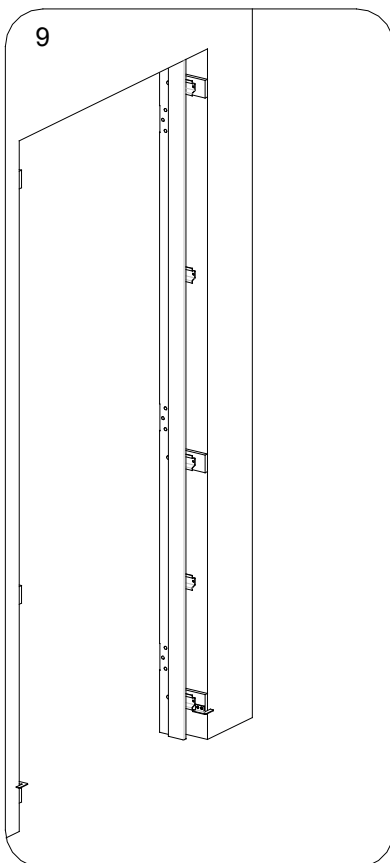

9a Closing side: fasten a wall bracket, rotated 180° with respect to the hanging side, onto the mounting block using two wood screws (Note! Not supplied) on the back half side.

9b Position the wall bracket with the lip downwards and make sure that it is properly flush against the wall.

When positioning the back half, make sure the frame profile slides onto the wall brackets.

DuoFlex frame, fire resistant

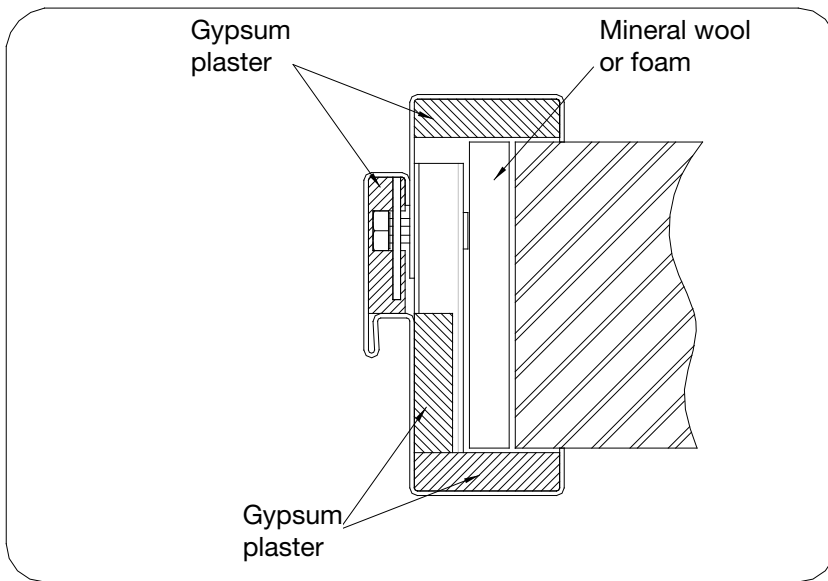

The front half and back half of the fire resistant model are both filled with gypsum plaster.

For the frame to satisfy the fire-resistant frame requirements, the frame must be installed according to the instructions in the reports listed below.

The instructions in the reports listed below take precedence over the instructions in the assembly manual.

Benor

30 minutes, single door

Frame must be filled with mineral wool or suitable foam or a combination of both.

30 minutes, double door

Frame must be filled with gypsum plaster.

60 minutes, single or double door

Frame must be filled with gypsum plaster.

Nen6069

30 minutes, single or double door

The frame does not need to be filled to be fire resistant.

(The frame may need to be filled for other purposes, for example, with wool for sound proofing.)

60 minutes, single or double door frame must be filled with gypsum plaster.

DuoFlex frame, fire resistant - filled with foam

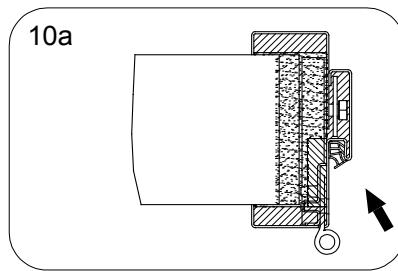
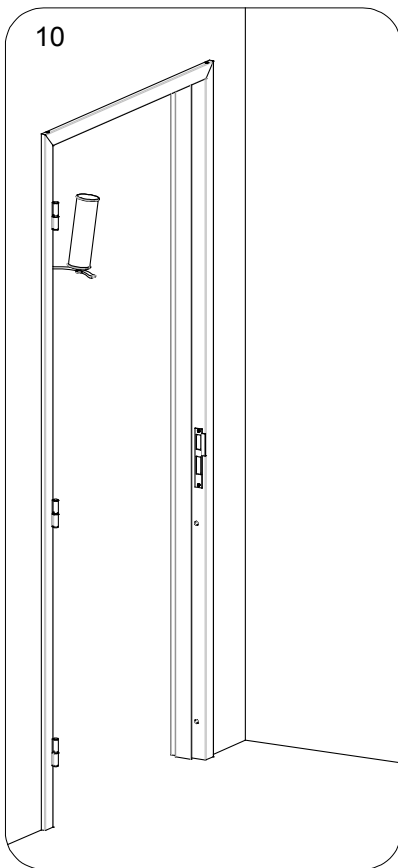

Assemble the DuoFlex frame according to the assembly instructions. Do not yet fit the stripping.

Carefully read the user instructions for the foam cannister. The grooves for the stripping have openings for the filler.

Fill the frame with the foam. Use acetone to immediately remove wet spots and residue. Remove hardened residue with suitable tools. Avoid damaging the frame.

10a Fit the seal.

DuoFlex frame fire resistant - filled with mineral wool

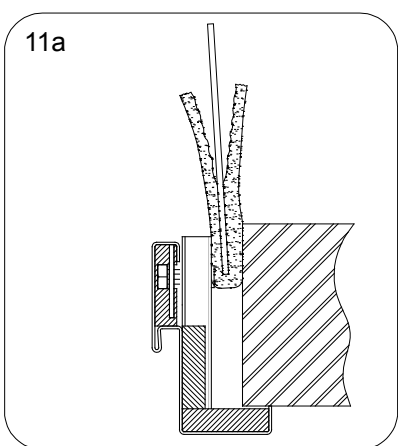
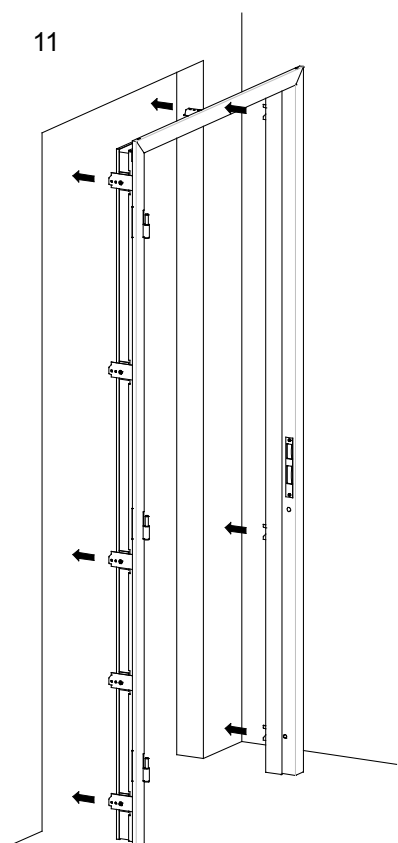

First mount the mounting blocks and the front half according to the assembly instructions, points 4 and 5.

11a Fill the front half completely with 30 mm of mineral wool.

Fold the wool around a sheet of plywood. With the smooth side outward, push it gently into the frame profile.

Place the back half according to the assembly instructions, point 6.

Place the wall brackets according to the assembly instructions for wall thickness of 150 mm or more, points 8 and 9.

Fit the seal.

DuoFlex frame fire resistant - filled with a combination of mineral wool and foam

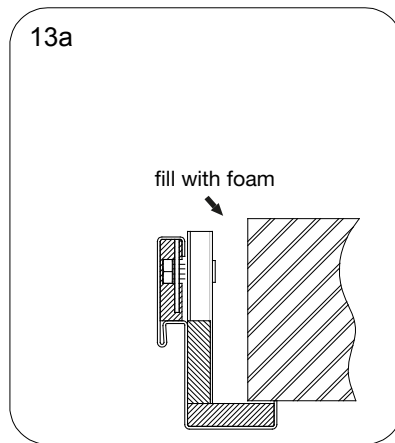
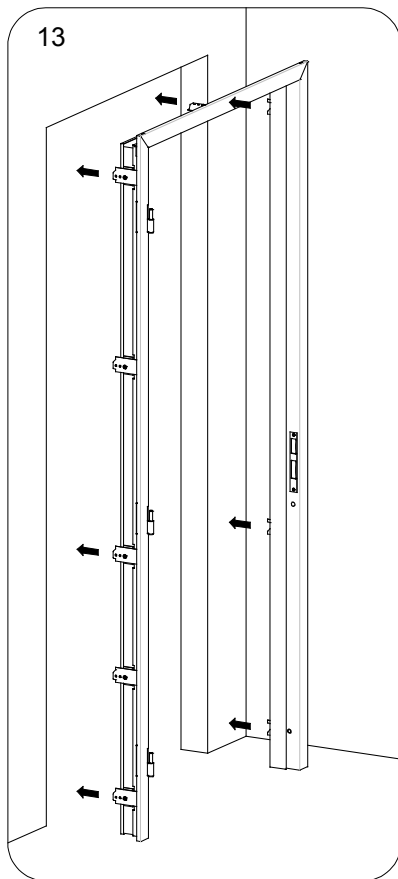

First mount the mounting blocks and the front half according to the assembly instructions, points 4 and 5.

Fit the seal.

13a Fill the front half completely with foam. Place the back half according to the assembly instructions, point 6.

Along with a strip of mineral wool. This must occur before the foam hardens.

Place the wall brackets according to the assembly instructions for wall thickness of 150 mm or more, points 8 and 9.

DuoFlex frame fire resistant - filled with gypsum plaster

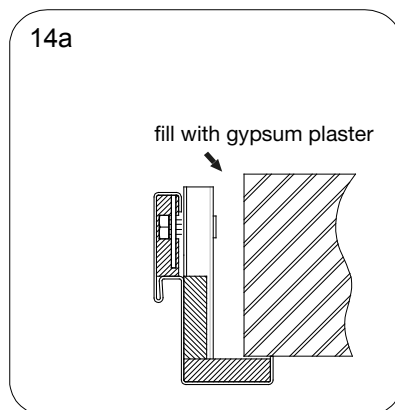
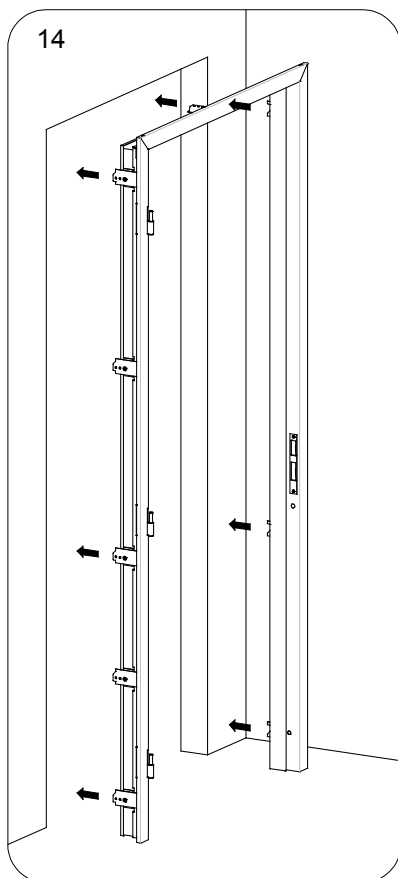

First mount the mounting blocks and the front half according to the assembly instructions, points 4 and 5.

14a and 14b Fill the front half completely with gypsum plaster.

Place the back half according to the assembly instructions, point 6. This must occur before the gypsum plaster hardens. Place the wall brackets according to the assembly instructions for wall thickness of 150 mm or more, points 8 and 9.

Fit the seal.

You can fill the front half with the gypsum plaster using special equipment that is available on the market.

