

Assembly guide

for sliding door system in wall - Utility

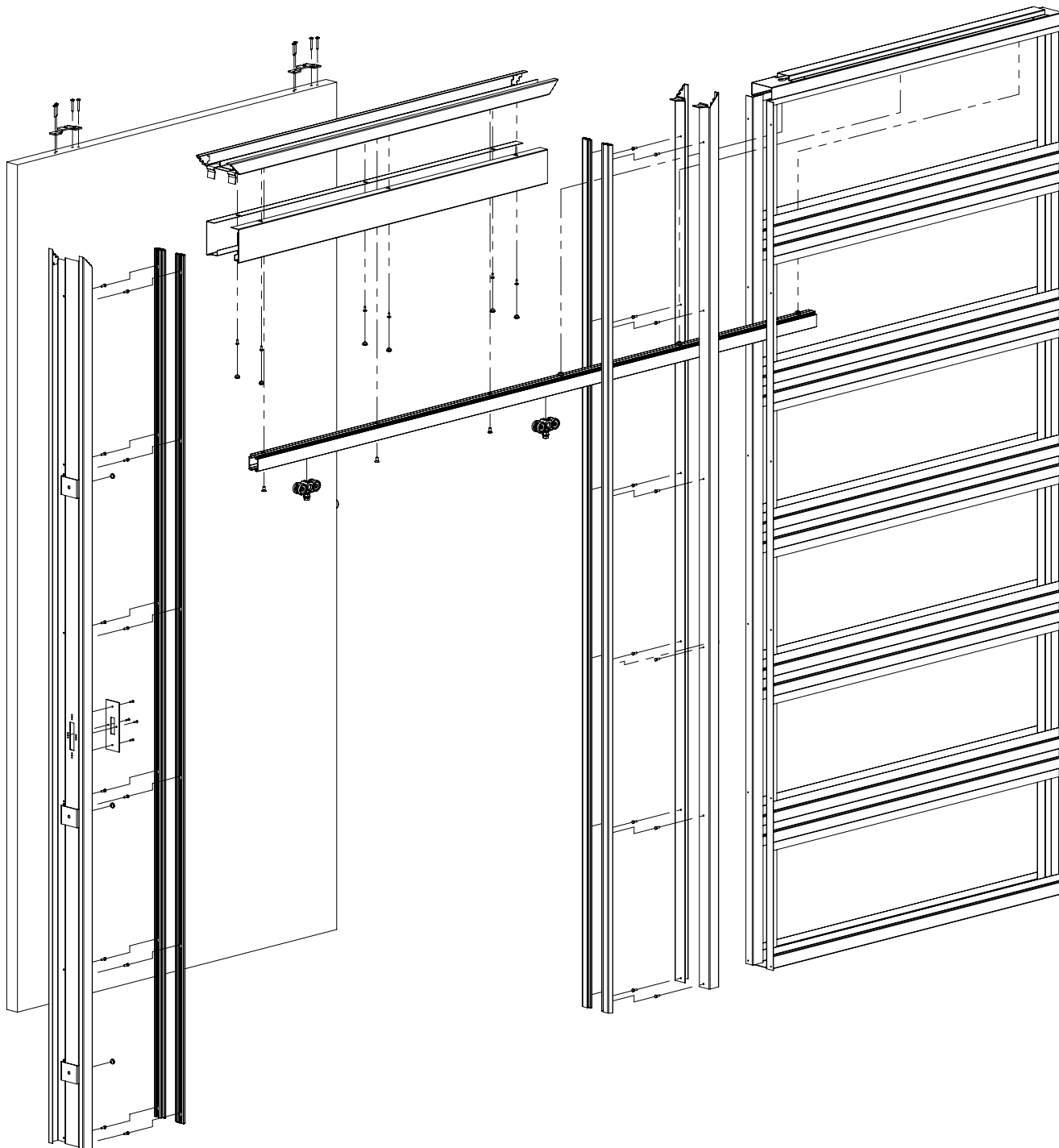

Models overview

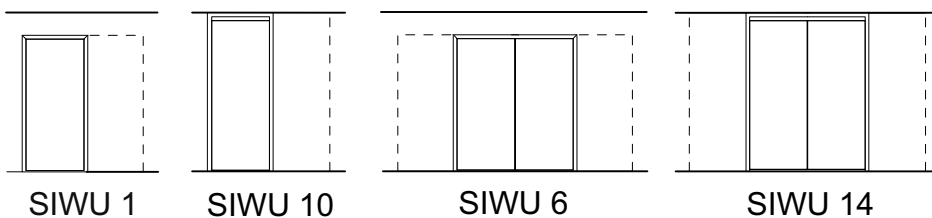

Contents

How to use this guide	3
Preparations openings single sliding door	4
Preparations openings double sliding door	5
Parts	6
Mounting of frame and hanging of single door	7
Mounting of frame and hanging of double sliding door	14

How to use this guide

This guide will provide you with clear step by step instructions for the assembly of the sliding door system in the wall Utility. This guide consists of illustrated and textual instructions. The numbers in the illustrations refer to the order of assembly of the parts and also refer to the numbers in the text.

The list with tools and parts shows the correct names. The parts and tools are also mentioned in the order of assembly.

For assembly of the frame and connecting the plating on the wall, the opening should be provided with wooden slats. Take into account that the wooden slats as well as the closet's plating are not provided by Theuma.

Modifications reserved.

Models overview

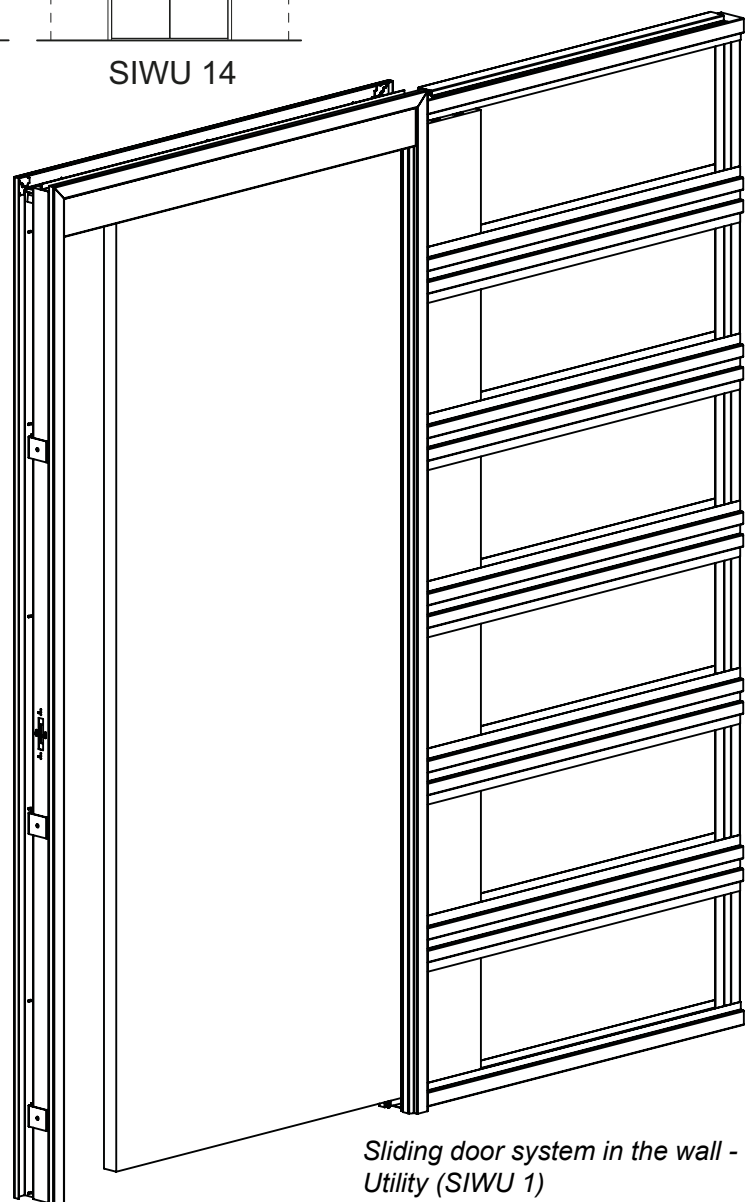
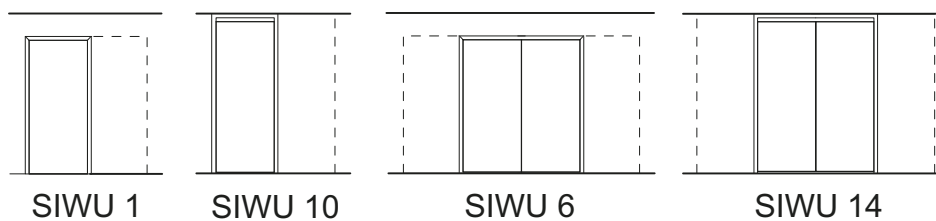

Sliding door system in the wall - Utility (SIWU 1)

Preparations openings single sliding door

1. Provide the opening with the necessary wooden slats.

Pay attention: the given opening dimension is without wooden slat.

Wooden slats and plating of the sliding door closet are not provided by Theuma!

Slat C (closing side of door) only when connecting to a right-angled wall, see section B. Make sure the opening dimensions are according to the prescribed mounting dimensions of your frame.

Cross section wooden slats:

Wall thickness Slat B Slat C (only when mounted to a right-angled wall)

100mm:	75 x 25 mm	100 x 20 mm
125mm:	75 x 25 mm	125 x 20 mm
150mm:	75 x 25 mm	150 x 20 mm

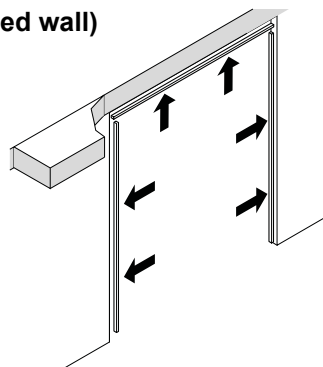

Single door sliding door system

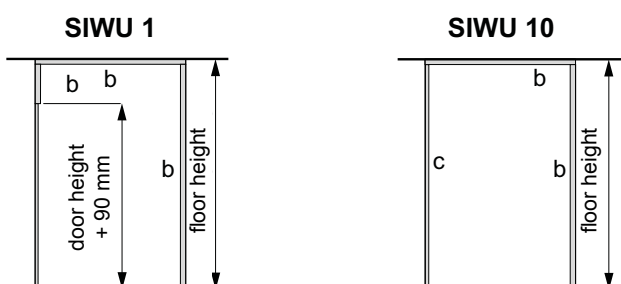

Horizontal section

SIWU 1 en SIWU 10



door width	section A wall opening (2x door width - 50)	section B wall opening (2x door width - 30)
980	1910	1930
1030	2010	2030
1130	2210	2230
1180	2310	2330
1230	2410	2430

Vertical section

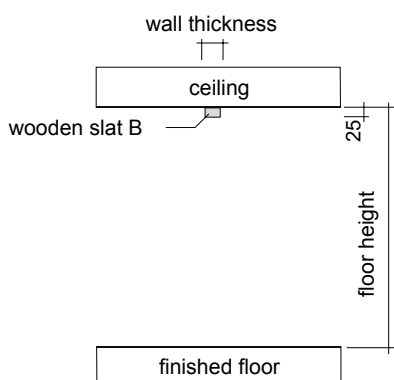

Finishing space between frame and ceiling (after frame mounting)

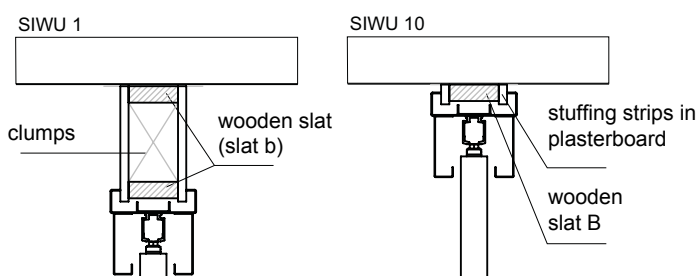

Preparations openings double sliding door

1. Provide the opening with the necessary wooden slats.

Pay attention: the given opening dimension is without wooden slat.

Wooden slats and plating of the sliding door closet are not provided by Theuma!

Make sure the opening dimensions are according to the prescribed mounting dimensions of your frame.

Cross section wooden slats:

Wall thickness	Slat B
100 mm:	75 x 25 mm
125 mm:	75 x 25 mm
150 mm:	75 x 25 mm

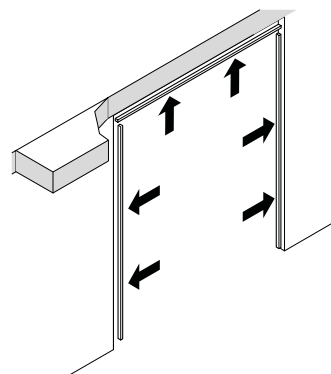

Silence sliding door system - double door

SIWU 6 en SIWU 14

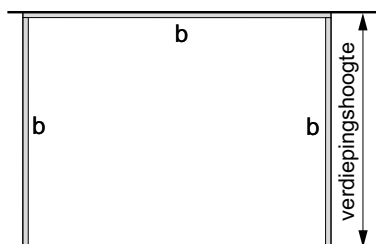

Horizontal section

SIWU 6 en SIWU 14

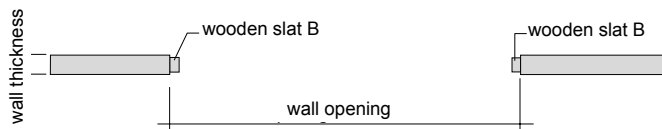

door width	wall opening (4x door width - 148)
980/980	3772
1030/1030	3972
1130/1130	4372
1230/1230	4772

Vertical section

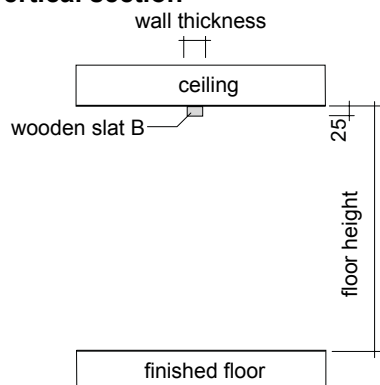

Finishing space between frame and ceiling (after frame mounting)

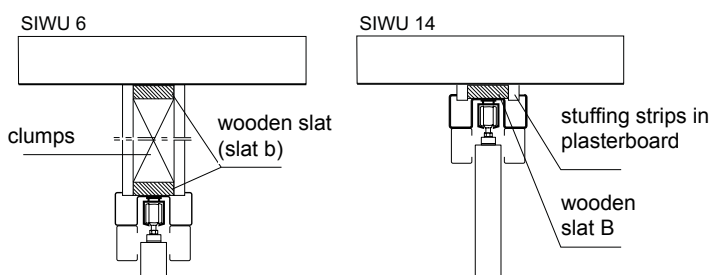

Parts







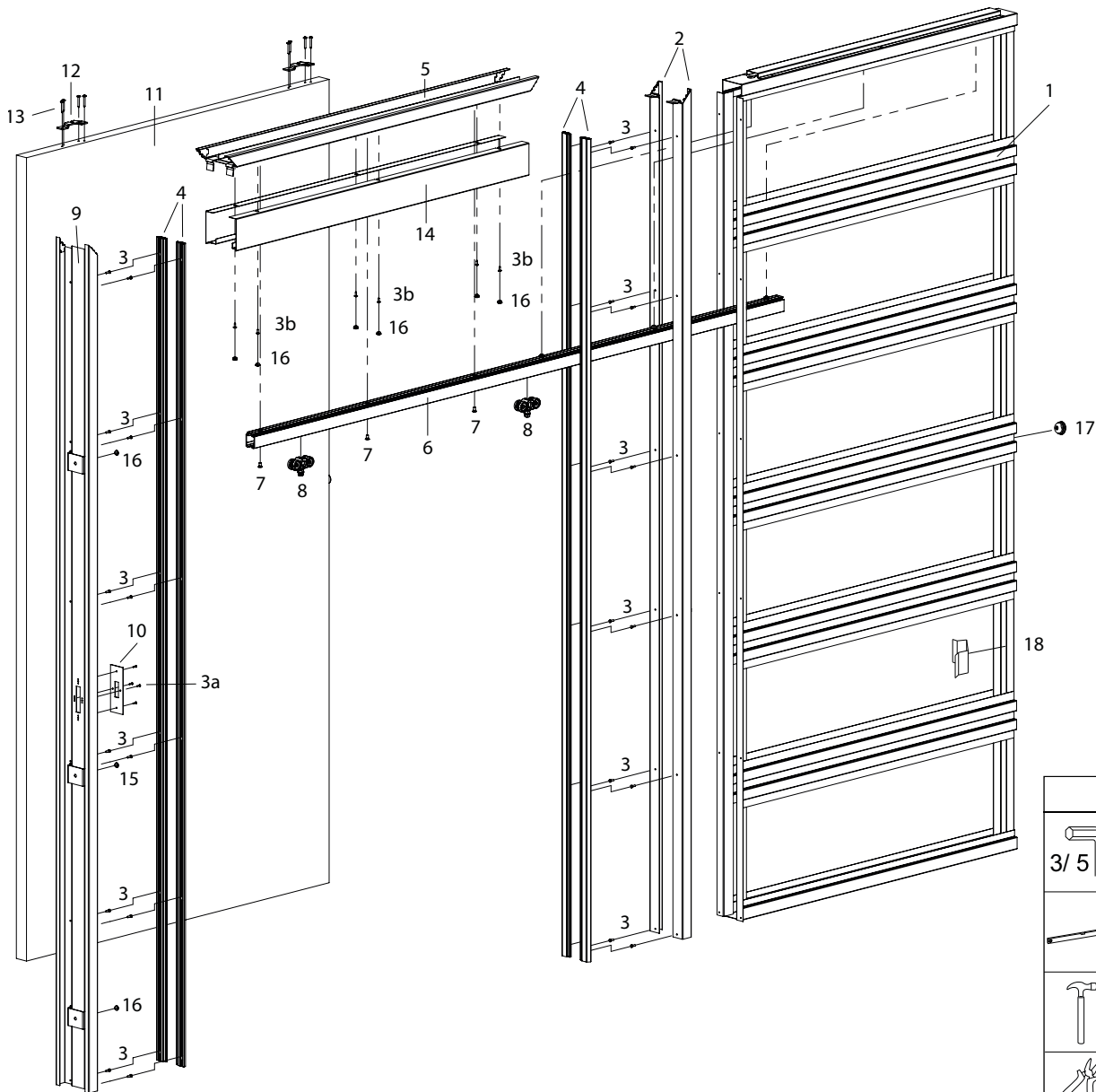

2. Take the parts out of the packaging.

Pay attention!

Prevent damage to the profiles.

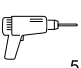
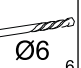
Place protective material under the profiles when assembling the frame.

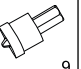

Tools		
		
3/ 5	1	2
		
4	5	6
		
7	8	9
		
10		

Parts

1. Niche closet
2. Run-through jambs
3. Parker head screws
- 3a. pop rivets
- 3b. round head parker screws
4. Dust sealing profiles
5. Upper sill
6. Aluminium rail
7. Sunken M6 bolts
8. Trolleys
9. Closing jamb
10. Lock plate
11. Door
12. Bearing plate
13. Chipboard screw Ø4 x 40
14. Cover frame
15. Door buffer
16. Sealing cap
17. Large door buffer
18. Entrance profile

Tools

1. Allen key, nr. 3 and 5
2. Screwing machine
3. Pencil
4. Level
5. Drill
6. Stone drill Ø6
7. Wooden or rubber hammer
8. Wrench, slw. 13
9. Plasterboard bit
10. Flat nose pliers
11. Pop rivet pliers

Mounting of frame and hanging of single door

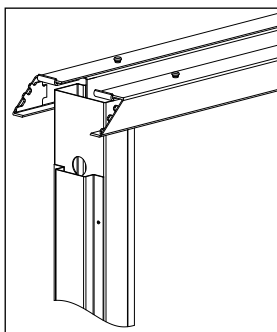
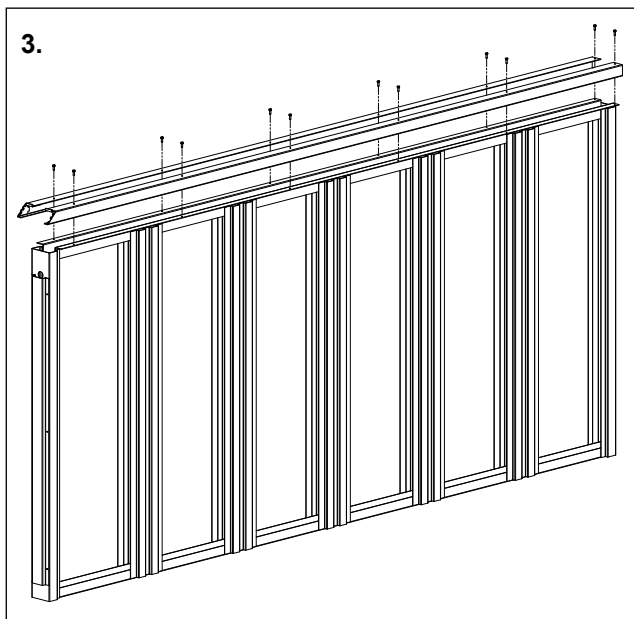

3. Place the niche closet with the open side upwards on the floor. Mount the run-through jambs using the parker head screws.

Pay attention! Make sure that when placing the upper parker head screws (by the mitre), you choose the hole closest to the turned over edge of the lacquered part.

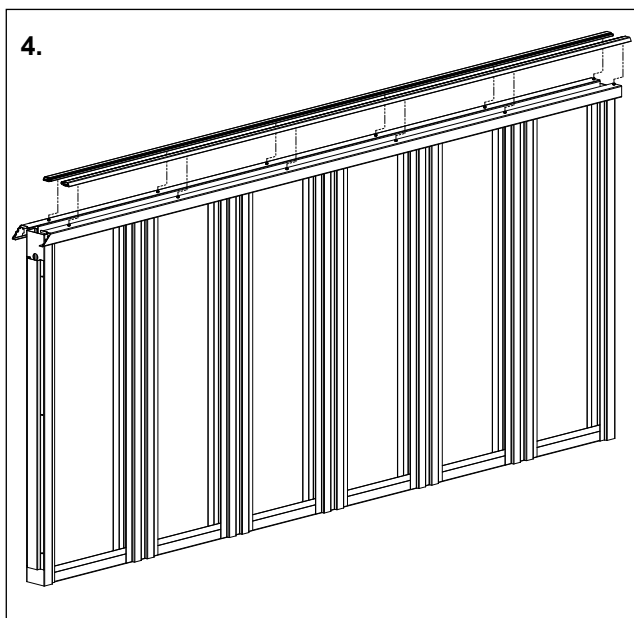

4. Mount the aluminium dust sealing profiles on the run-through jamb. Use a wooden or rubber hammer for this.

Place the slotted holes on the backside of the profile over the parker head screws, such that the aluminium dust sealing profile sticks out from the non-mitre side.

Using the hammer, tick the profile until it is even with the lower side of the run-through jamb.

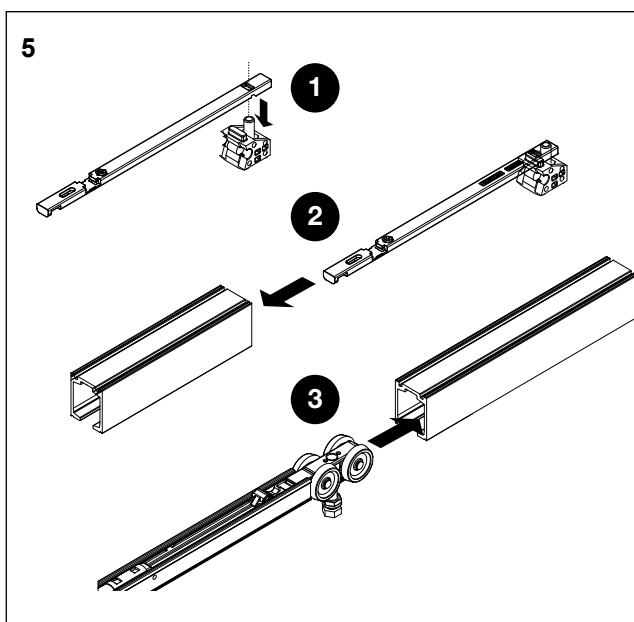

5. **PAY ATTENTION: in case of soft-close, single side or double sided:**

Place the activator and the end stopper in the rail and fix it (5.1 and 5.2).

Slide the soft-close into the rail. Pay attention, the spring/springs have to be tensioned (5.3)

With double soft-close: repeat steps 5.1 until 5.3 with the second stopper and soft-close.

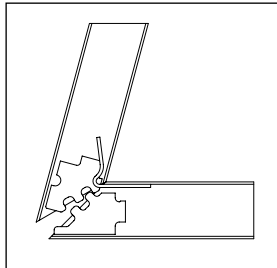
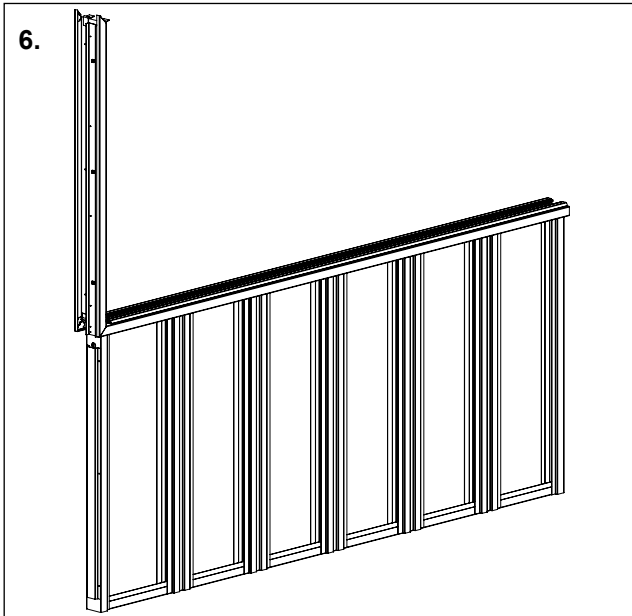

6. Place the transom of the frame by means of a turning movement in a horizontal position in relation to the niche closet.

Make sure the miters on both sides of the profile fit well into each other!

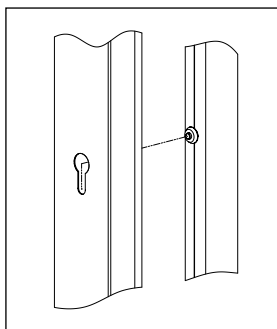
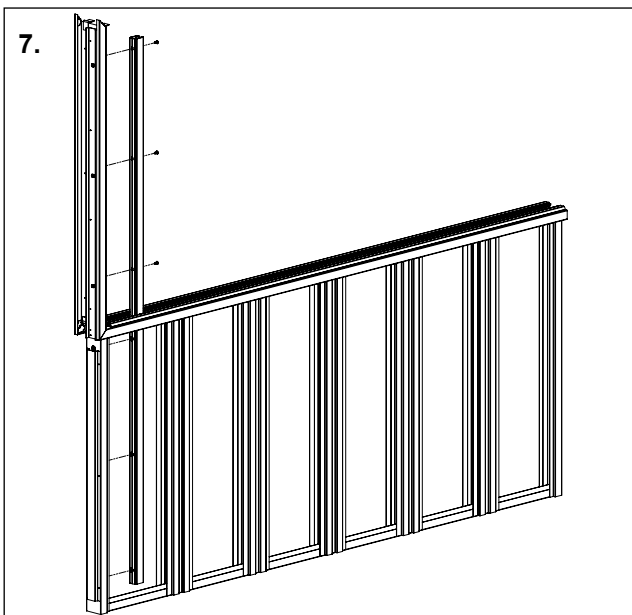
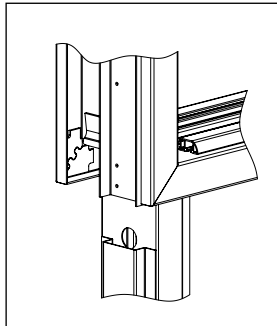

7. Place the aluminium rail in such a way that the pre-assembled brass fasteners fit into the keyholes of the niche closet and allow the rail to slide in place.

Connect the aluminium rail by means of the sunken M6 bolts to the frame's transom.

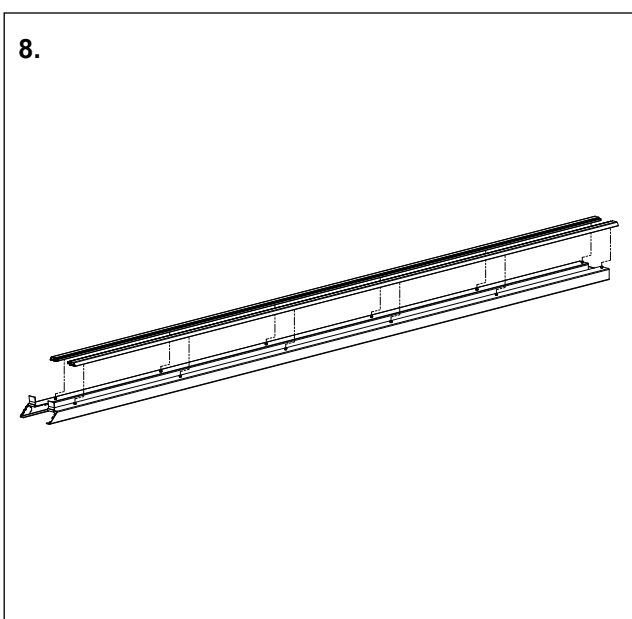

8. Mount the aluminium dust sealing profiles on the closing jamb. Use a wooden or rubber hammer for this.

Place the slotted holes on the backside of the profile over the parker head screws, such that the aluminium dust sealing profile sticks out from the non-mitre side.

Using the hammer, tick the profile until it is even with the lower side of the closing jamb.

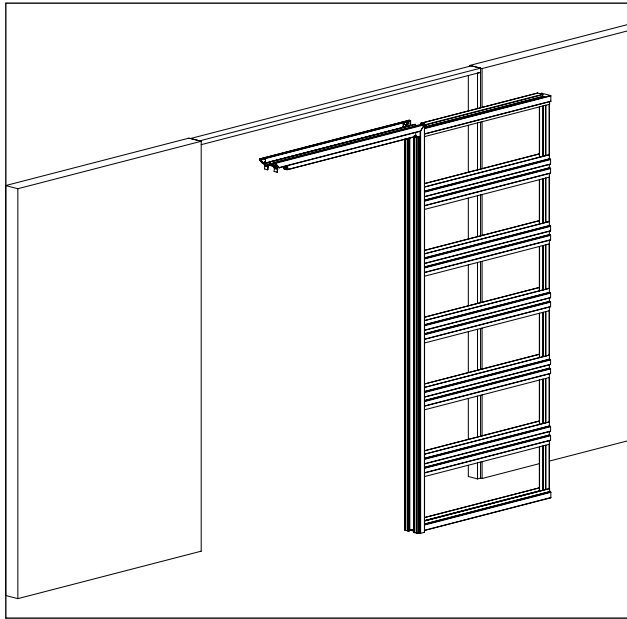
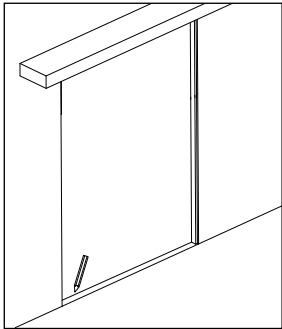
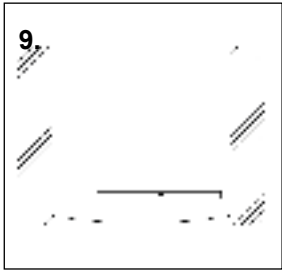

9. Check the floor beforehand using a long level for angularity and flatness. You can take this information into account during the placement of the element.

Draw two parallel lines on the floor in the opening.

(distance = wall thickness).

Place the half-mounted element in the opening and make sure that the open side of the transom is wall-comprehensive.

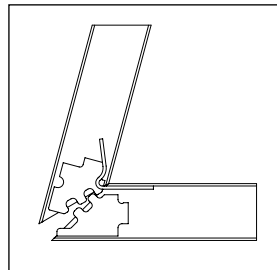
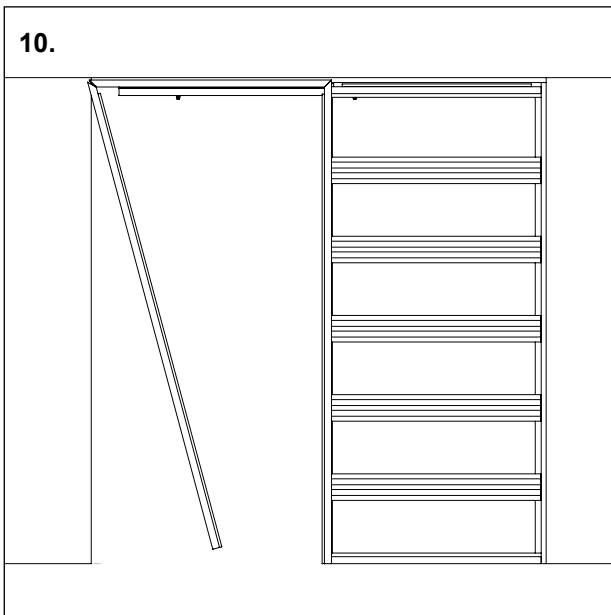

10. Place the closing jamb with a turning motion around the wall such that the miters grip correctly into each other.

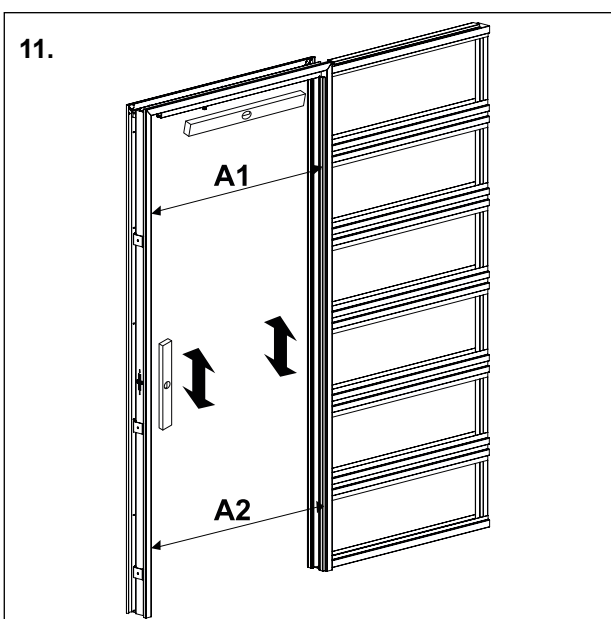

11.

- a. Put the closing jamb level
- b. Put the complete transom level, including the closet part, and where necessary fill up.
- c. Fix the closing jamb using chipboard screws/plugs. Screws and plugs are not provided by Theuma.
- d. Place the run-through jambs parallel to the closing jamb and check if dimension $A1=A2$

Mounting tip: turn the screws partially into the wall, such that you can place the closing jamb and possibly fill out. After levelling, tighten the screws.

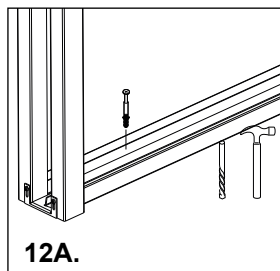
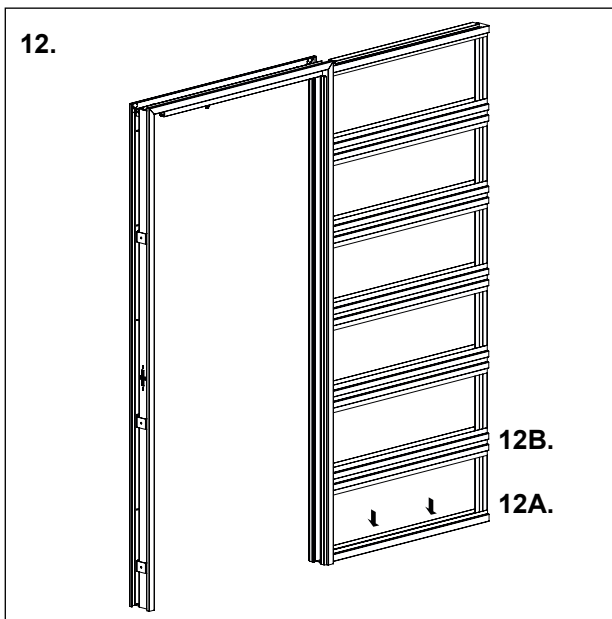

12. Install the ground ruler of the niche closet. **PAY ATTENTION**, the ground ruler should be parallel with the two lines and exactly in the middle.

With stone-like floors, drill a 6 mm hole, fix nail plugs 6 x 40. Screws and plugs are not provided by Theuma.

If the floor is not level, filler should be foreseen under the ground ruler.

12B. Mount the lower reinforcement profiles in the niche closet. Place the holes into the profiles around the hooks of the run-through jambs and the end profile. Tap the profiles with a hammer. Start on the side of the run-through jambs.

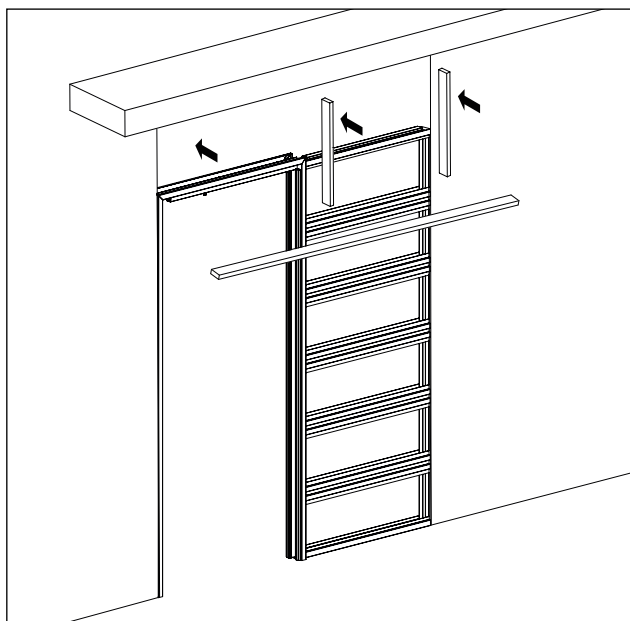
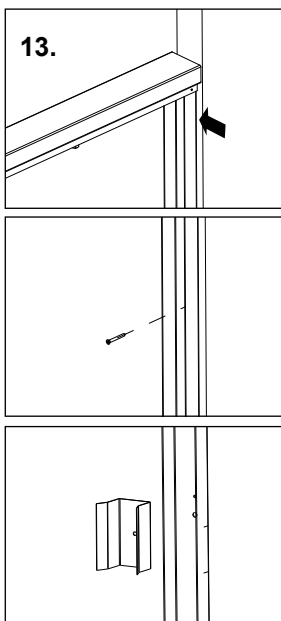

13. Connect the end profile of the niche closet to the wall and fill the space between closing jamb and wall with multiplex.

Use chipboard screws to connect the end profile.

Mount the entrance profile with the two lower screws.

For the SIWU 1:

Above the frame, attach slats (25x75/100) for connecting the plate material. Screws, plugs and slats are not provided by Theuma.

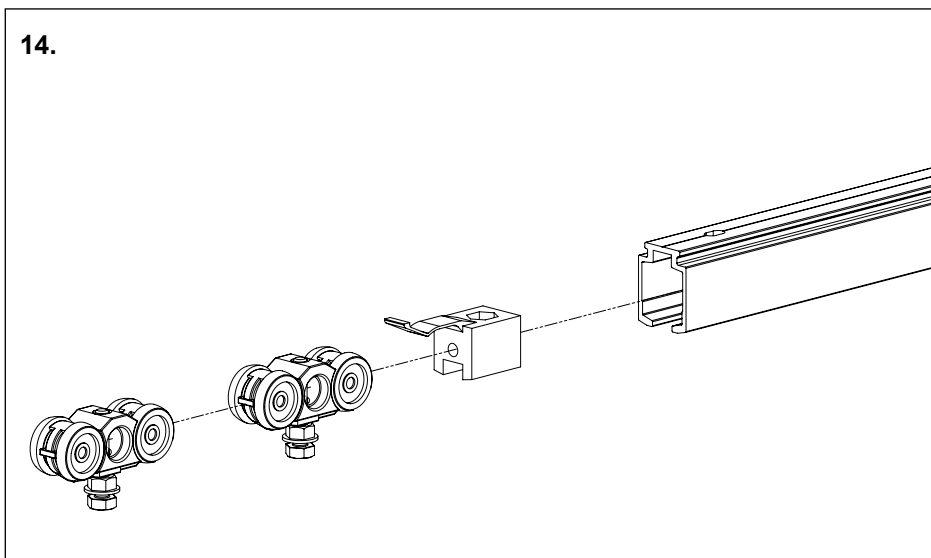

14. **PAY ATTENTION: if not soft-close**, place the trolleys, and if fixation of the door is desired, place the end stopper in the rail.

The trolleys and end stopper will be adapted and fastened later.

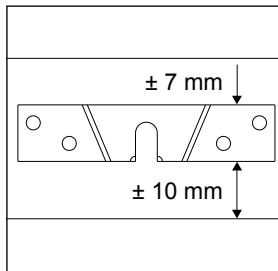
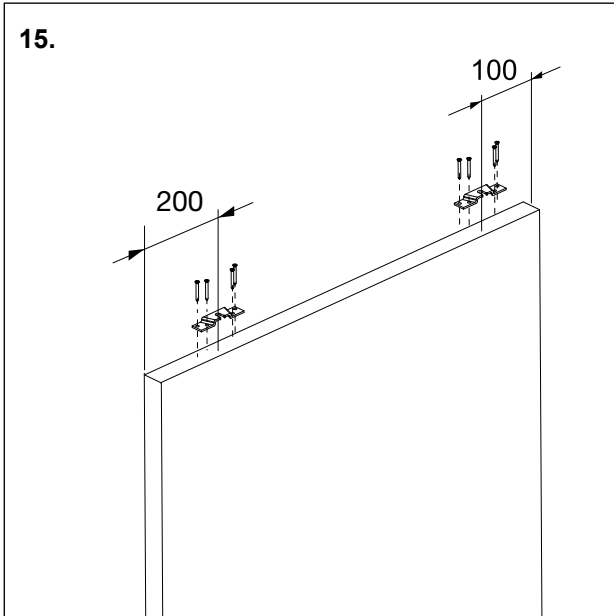

15. **PAY ATTENTION:** if not soft-close,

screw the bearing plates on the upper side of the door.

Pay attention!

Front side door - heart bearing plate = 200 mm.

Backside door - heart bearing plate = 100 mm.

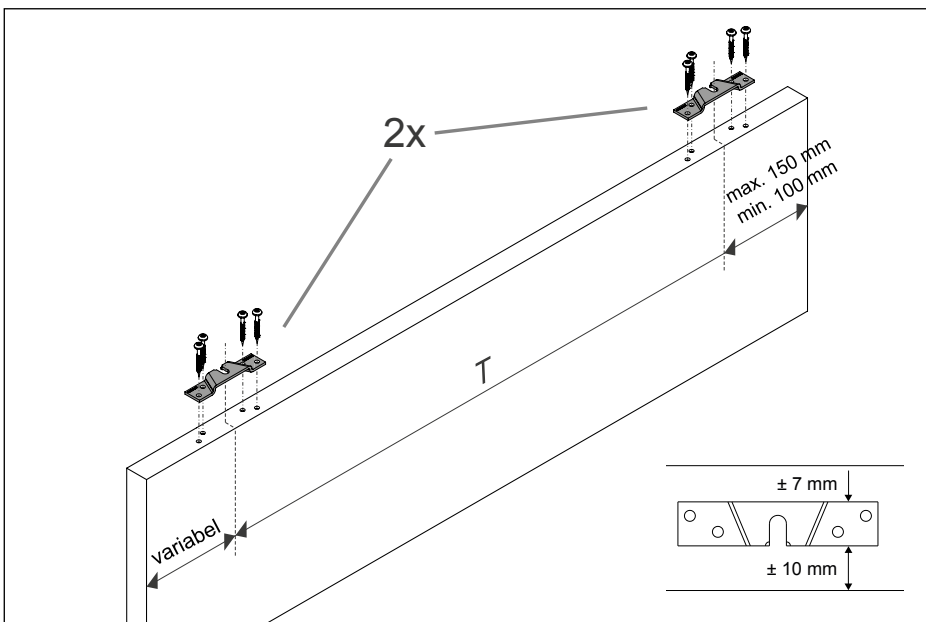

PAY ATTENTION: if soft-close,

Determine dimension T using the table.

screw the bearing plates on the upper side of the door.

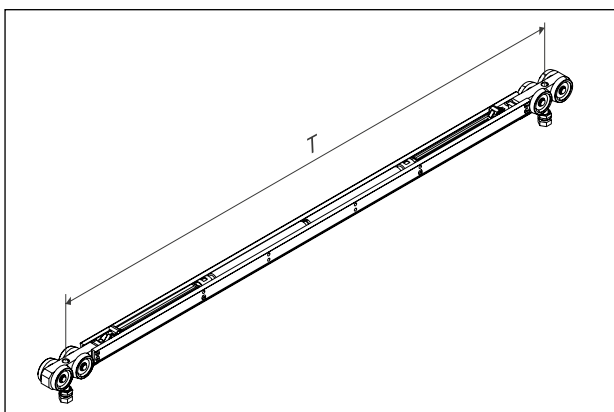

	Version	T (mm)	Door width
Single soft-close	kort	414	574-900
	lang	740	900-1290
Double soft-close	kort	624	784-1290
	lang	1130	1290-1700

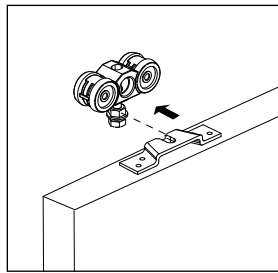
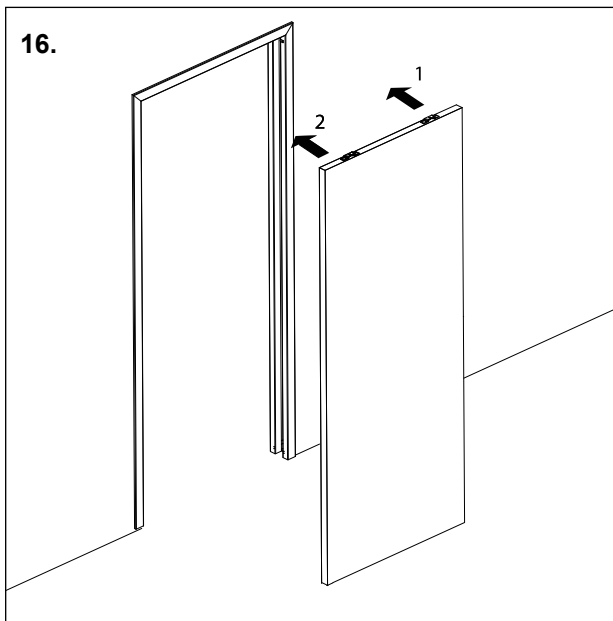

16. Hang the door with the bearing plates on the trolleys. First the backside, then the front.

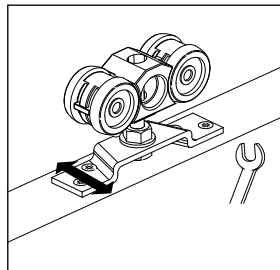
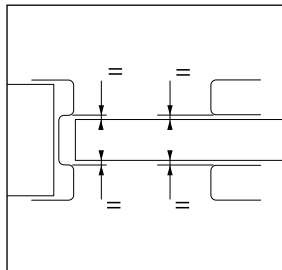
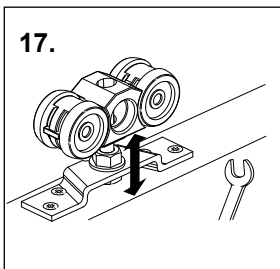

17. Adjust the door as follows:

Height adjustment: the bolt on the trolleys is for height adjustment and for placing the closing side of the door parallel with the closing jamb. Adjust the space between bottom of the door and floor to approximately 20 mm. Adjustment with ± 5 mm is possible.

Slide the door such that the space between the run-through jambs and the door is equal on both sides.

After adjustment, tighten the nut.

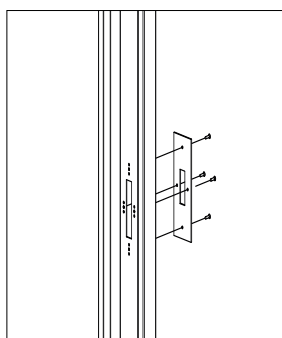
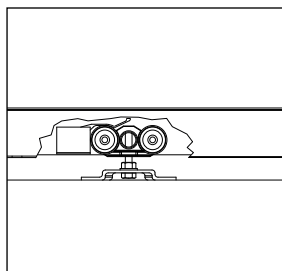
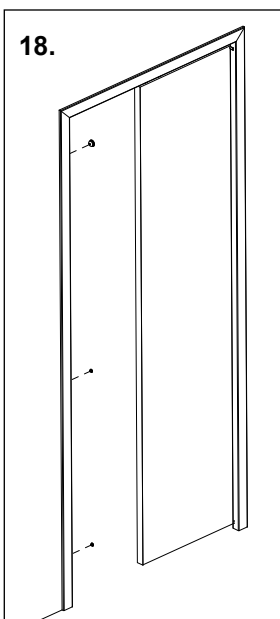

18. Push the door buffers in the holes of the closing jamb.

Adjust the end stoppers and secure these.

Mount and adjust the closing plate using the sunken head screws.

Pay attention! Make sure the door has no play when it is closed.

19.

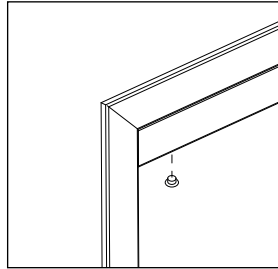
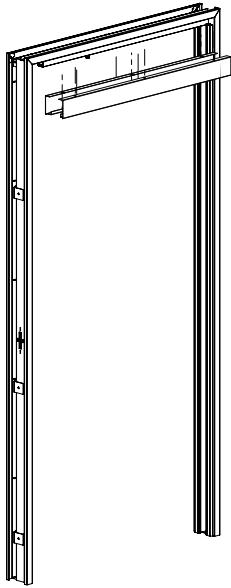

18. Attach the round head parker screws in the transom. Let these stick out by approximately 5 mm.

Slide the covering jambs over the extending round head parker screws.

Press the jambs and tighten the parker screws.

Attach the sealing caps.

20.

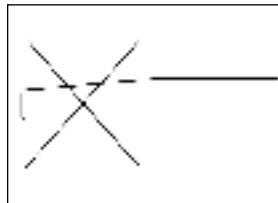
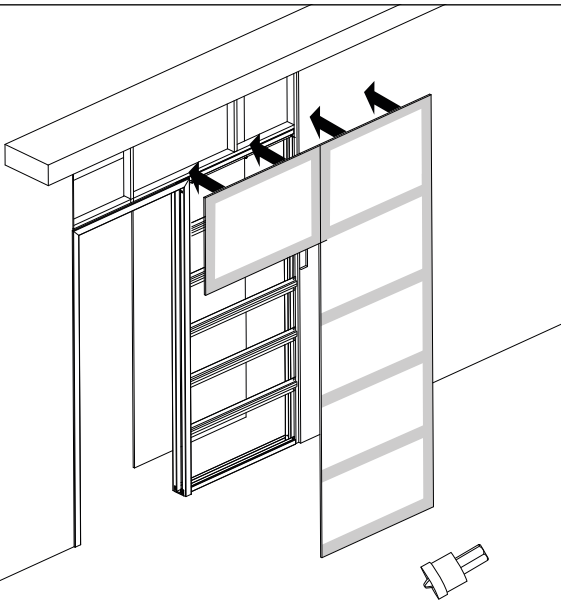

19. The closet part is now ready to be finished with 12,5 mm plasterboard

Pay attention! In wet spaces, apply the correct (waterproof) materials.

Remove the slanting end of the plasterboard. This ensures extra stiffness of the wall.

Slide the panel approx. 30 mm into the run-through jamb.

Screw the plate tight in the shaded portion (see figure 19) using the provided plasterboard screws. Pay attention, use a plasterboard bit for this.

Also attach a panel above the door opening. Also adjust the other side of the frame with 12,5 mm plasterboard.

You can increase the wall thickness by mounting a second or a third plasterboard. Make sure the seams of the different layers overlap.

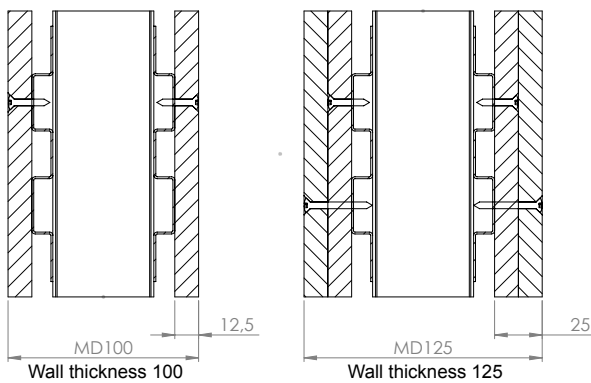
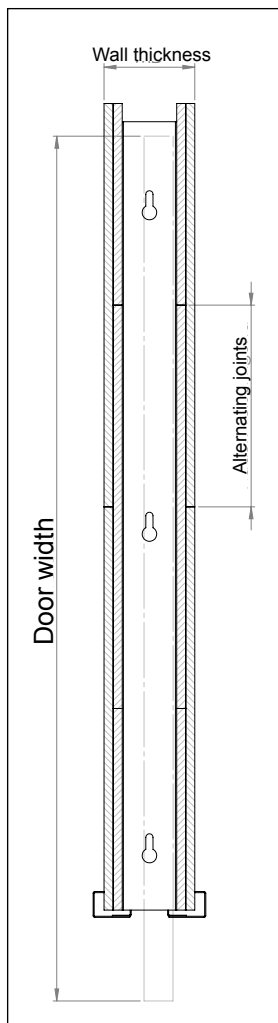

Mounting of frame and hanging of double sliding door

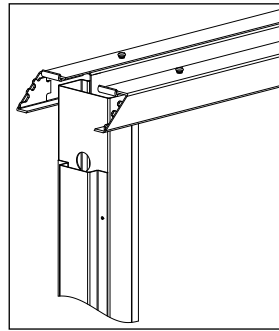
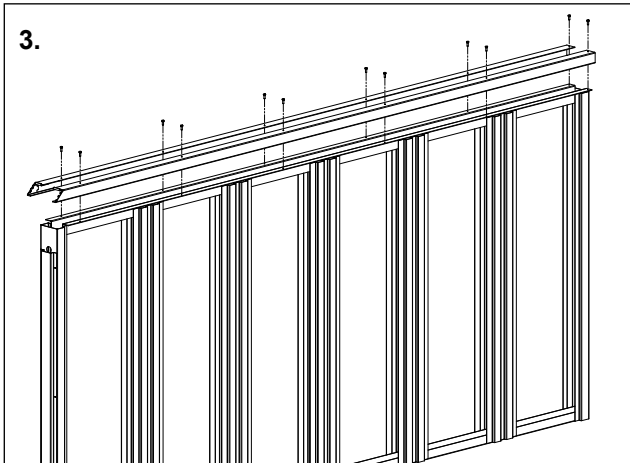

3. Place the niche closet with the open side upwards on the floor. Mount the run-through jambs using the parker head screws.

Pay attention! Make sure that when placing the upper parker head screws (by the mitre), you choose the hole closest to the turned over edge of the lacquered part.

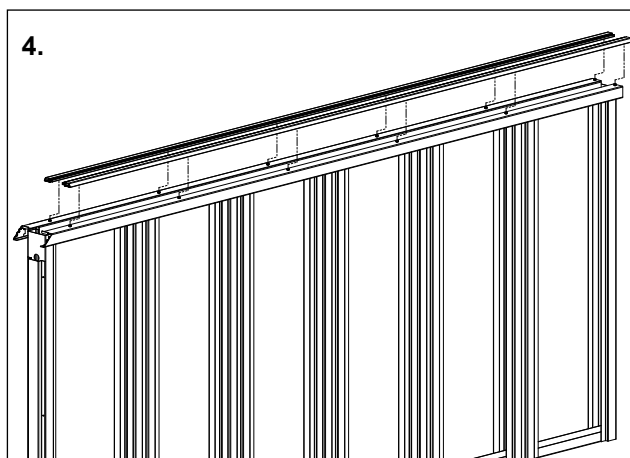

4. Mount the aluminium dust sealing profiles on the run-through jamb. Use a wooden or rubber hammer for this.

Place the slotted holes on the backside of the profile over the parker head screws, such that the aluminium dust sealing profile sticks out from the non-mitre side.

Using the hammer, tick the profile until it is even with the lower side of the run-through jamb.

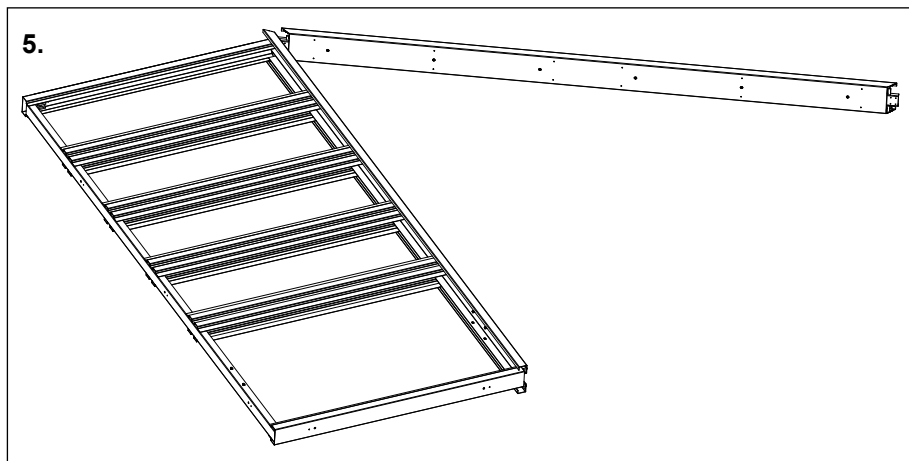

5. Place the welded niche closet with the mounted run-through jambs on the floor. **Pay attention:** prevent damage to the profiles. Place protective material under the profiles when assembling the frame.

A. Mount the transom by putting the lips into the contras under a small angle.

B. Make sure the teeth hook well into each other by turning the transom in a straight line with the closet's transom. Make sure the side surfaces are equal.

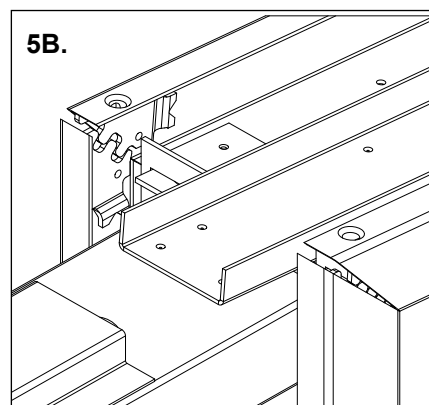
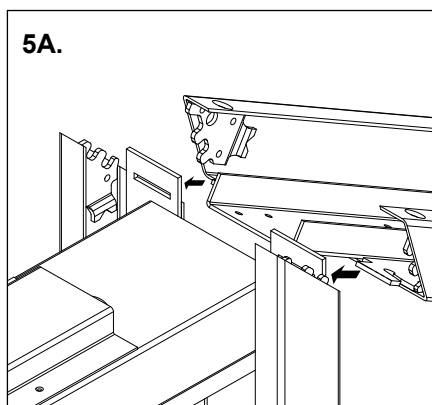

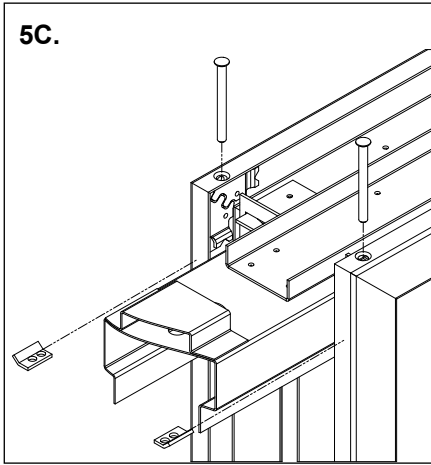

5C.

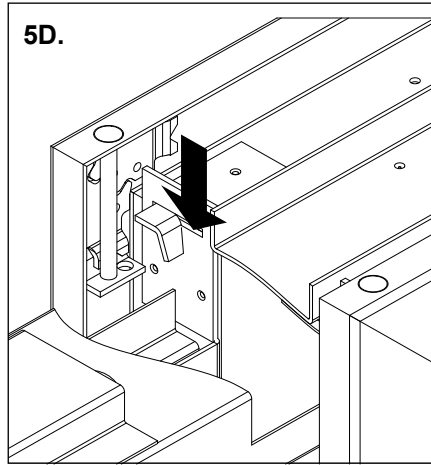

5D.

5.

C. Place the connection bracket and fix it with the sunken screw.

D. Twist the lips inside.

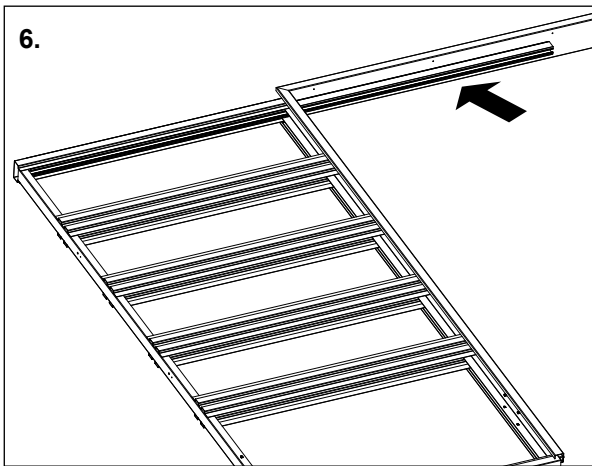

6.

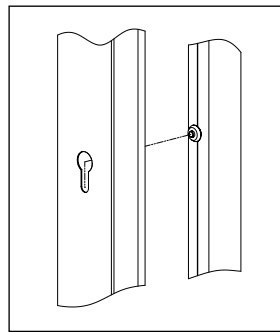

6. Place the aluminium rail in such a way that the pre-assembled brass fasteners fit into the keyholes of the niche closet and allow the rail to slide in place.

Connect the aluminium rail by means of the sunken M6 bolts to the frame's transom.

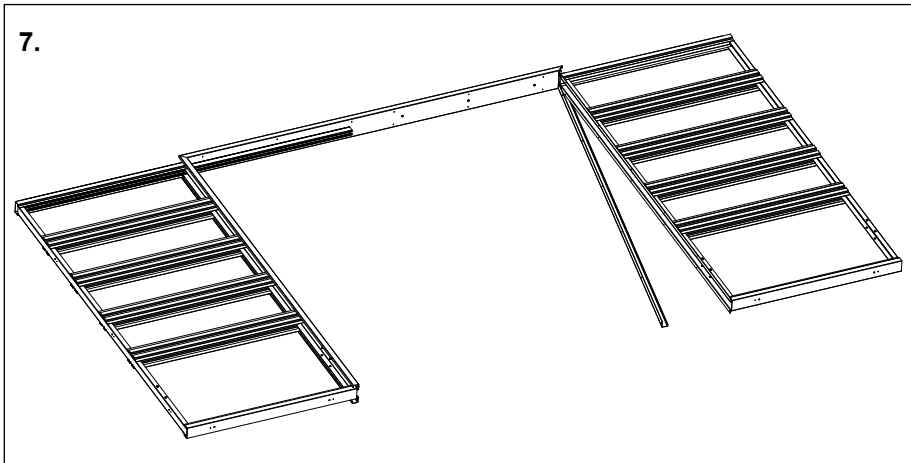

7.

7. Place the second niche closet in position with regard to the transom.

Take the lower run-through jamb and mount it by putting the lip into the contra under a small angle.

Make sure the teeth of the miter plates hook well into each other by

moving the run-through jamb towards the niche closet.

Mount the run-through jamb using the parker head screws.

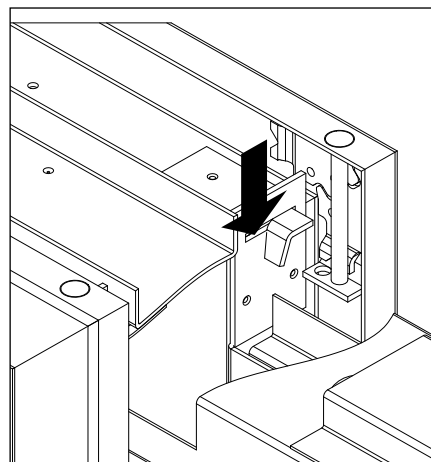
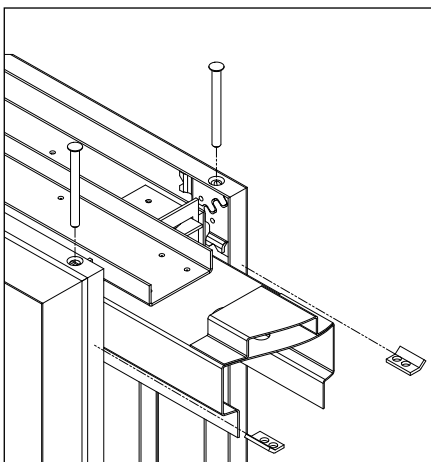

Take the upper run-through jamb and mount it in the same way as the lower run-through jamb.

Make sure the side surfaces are equal.

Place the connection bracket and fix it with the sunken screw.

Twist the lips.

Place the aluminium rail as described above.

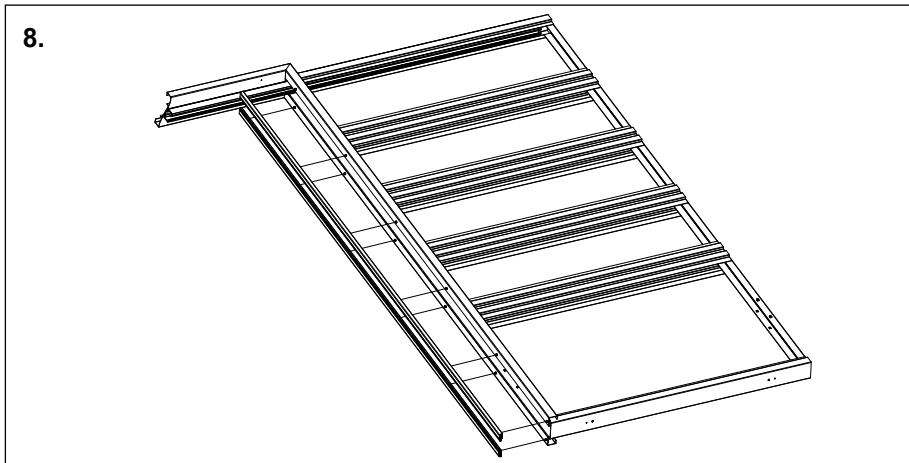

8. Mount the aluminium dust sealing profiles on the run-through jamb. Use a wooden or rubber hammer for this.

Place the slotted holes on the backside of the profile over the parker head screws, such that the aluminium dust sealing profile sticks out from the non-mitre side.

Using the hammer, tick the profile until it is even with the lower side of the run-through jamb.

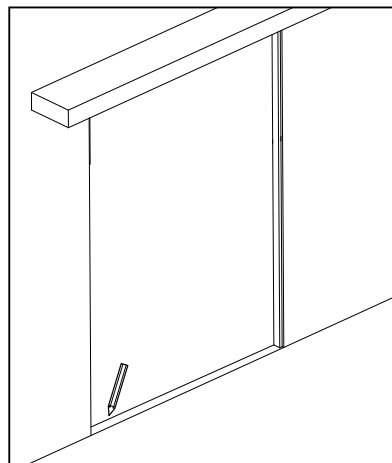
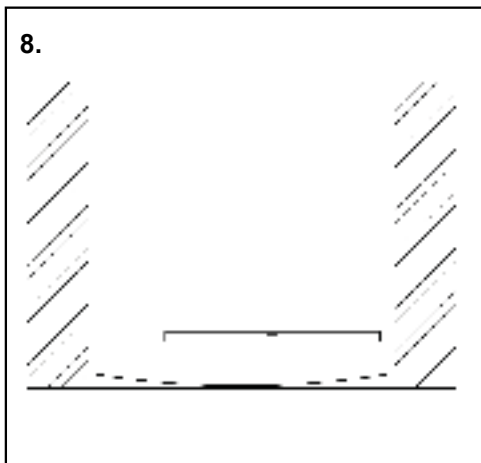

8. Check the floor beforehand using a long level for angularity and flatness. You can take this information into account during the placement of the element.

Draw two parallel lines on the floor in the opening. (distance = wall thickness).

9. Place the element in the opening.

10. Put the element level, as described in step 11 on page 9.

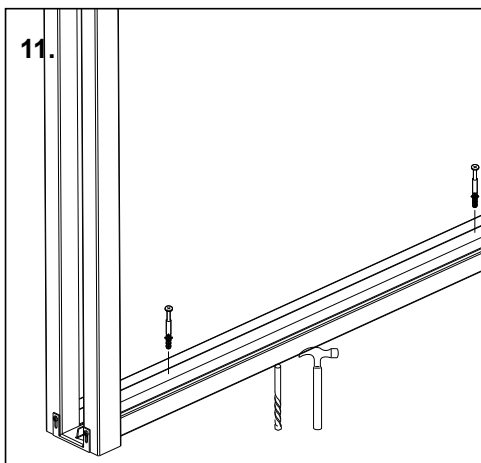

11. Install the ground ruler of the niche closet. **PAY ATTENTION**, the ground ruler should be parallel with the two lines and exactly in the middle.

With stone-like floors, drill a 6 mm hole, fix nail plugs 6 x 40. Screws and plugs are not provided by Theuma.

If the floor is not level, filler should be foreseen under the ground ruler.

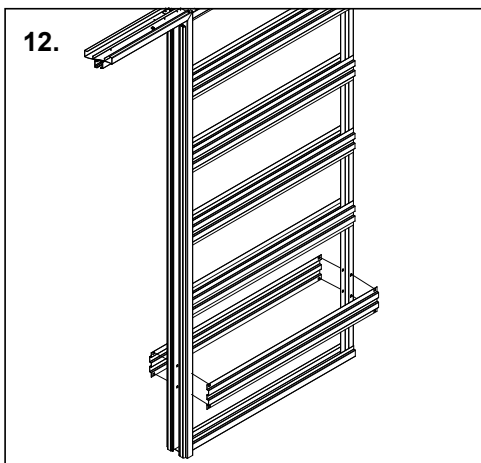

12. Mount the reinforcement profiles in the niche closets.

Place the holes into the reinforcement profiles around the hooks of the run-through jambs and the closing profile. Tap the reinforcement profiles with a hammer. Pay attention! Start on the side of the run-through jambs.

Then execute steps 13 until 20 as described for the single sliding door.



Het keurmerk voor
Verantwoord
bosbeheer

